



HYDRAULIC FITTINGS

GMTBUN	NO SKIVE FERRULE FOR SAE 100 R1/2T – DIN EN 853 1/2SN
GMTB1T	NO SKIVE FERRULE FOR SAE 100 R1T – DIN EN 853 1SN
GMTB2T	NO SKIVE FERRULE FOR SAE 100 R2T – DIN EN 853 2SN
GMTB12	NO SKIVE FERRULE FOR SAE 100 R1/2T – DIN EN 853 1/2SN
GMTB1A	SKIVE FERRULE FOR SAE 100 R1A – DIN EN 853 1ST
GMTB2A	SKIVE FERRULE FOR SAE 100 R2A – DIN EN 853 2ST
GMTB4P	SKIVE FERRULE FOR SAE 100 R9R/R10/R12 – DIN EN 856 4SP
GMTB4H	SKIVE FERRULE FOR DIN EN 856 4SH
GMTB1C	NO SKIVE FERRULE FOR DIN EN 857 1SC
GMTBR7	NO SKIVE FERRULE FOR SAE 100 R7/R8 – DIN EN 855

FERRULE

GMTFG	BSP FEMALE, 60° CONE
GMTPFG	BSP FEMALE THRUST WIRE NUT, 60° CONE
GMTSFG	BSP FEMALE SLIP BACK NUT, 60° CONE
GMTFSPG	BSP FEMALE FLAT FACE
GMTC90G	BSP SWEPT 90° FEMALE, 60° CONE
GMTPC90G	BSP SWEPT 90° FEMALE THRUST WIRE NUT, 60° CONE
GMTSC90G	BSP SWEPT 90° FEMALE SLIP BACK NUT, 60° CONE
GMTC90COMP	BSP FEMALE 90° COMPACT ELBOW, 60° CONE
GMTC45G	BSP SWEPT 45° FEMALE, 60° CONE
GMTPC45G	BSP SWEPT 45° FEMALE THRUST WIRE NUT, 60° CONE
GMTSC45G	BSP SWEPT 45° FEMALE SLIP BACK NUT, 60° CONE
GMTOG	BSP BANJO
GMTMG	BSPP MALE, 60° SEAT
GMTMC	BSPT MALE, 60° SEAT
GMTMNPT	NPTF MALE

INSERTS BSP

INSERTS NPT



HYDRAULIC FITTINGS			
GMTFJ	JIC FEMALE, 37° SEAT	INSERTS JIC	
GMTPFJ	JIC FEMALE THRUST WIRE NUT, 37° SEAT		
GMTSFJ	JIC FEMALE SLIP BACK NUT, 37° SEAT		
GMTFJDE	JIC FEMALE DOUBLE HEXAGON, 37° SEAT		
GMTC90J	JIC SWEPT 90° FEMALE, 37° SEAT		
GMTPC90J	JIC SWEPT 90° FEMALE THRUST WIRE NUT, 37° SEAT		
GMTSC90J	JIC SWEPT 90° FEMALE SLIP BACK NUT, 37° SEAT		
GMTC90COMPJ	JIC FEMALE 90° COMPACT ELBOW, 37° SEAT		
GMTC45J	JIC SWEPT 45° FEMALE, 37° SEAT		
GMTPC45J	JIC SWEPT 45° FEMALE THRUST WIRE NUT, 37° SEAT		
GMTSC45J	JIC SWEPT 45° FEMALE SLIP BACK NUT, 37° SEAT		
GMTMJ	JIC MALE, 37° CONE		
GMTFEL	METRIC O-RING FEMALE, 24° CONE, DIN 3853 LIGHT		INSERTS DIN 24°
GMTC90EL	METRIC SWEPT 90° O-RING FEMALE, 24° CONE, DIN 3865 LIGHT		
GMTC45EL	METRIC SWEPT 45° O-RING FEMALE, 24° CONE, DIN 3865 LIGHT		
GMTMEL	METRIC MALE, 24° SEAT, DIN 3853 LIGHT		
GMTFES	METRIC O-RING FEMALE, 24° CONE, DIN 3865 HEAVY		
GMTC90ES	METRIC SWEPT 90° O-RING FEMALE, 24° CONE, DIN 3865 HEAVY		
GMTC45ES	METRIC SWEPT 45° O-RING FEMALE, 24° CONE, DIN 3865 HEAVY		
GMTMES	METRIC MALE, 24° SEAT, DIN 3853 HEAVY	STAND-PIPE	
GMTCOD	METRIC STANDPIPE, DIN 2353		
GMTCOD90	METRIC SWEPT 90° STANDPIPE, DIN 2353		
GMTCOD45	METRIC SWEPT 45° STANDPIPE, DIN 2353	INSERTS METRIC 60°	
GMTFM	METRIC FEMALE, 60° CONE		
GMTC90M	METRIC SWEPT 90° FEMALE, 60° CONE		
GMTC45M	METRIC SWEPT 45° FEMALE, 60° CONE		
GMTOM	METRIC BANJO		
GMTMM	METRIC MALE, 60° SEAT		

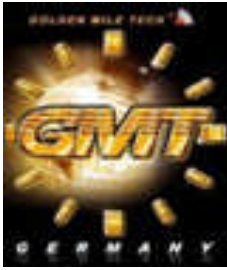

I HYDRAULIC FITTINGS			
GMTFLPI3	SAE FLANGE 3000 PSI - SAE J518	FLANGES	
GMTFLPI6	SAE FLANGE 6000 PSI - SAE J518		
GMTFLPI390	SAE FLANGE 3000 PSI SWEPT 90° - SAE J518		
GMTFLPI690	SAE FLANGE 6000 PSI SWEPT 90° - SAE J518		
GMTFLPI345	SAE FLANGE 3000 PSI SWEPT 45° - SAE J518		
GMTFLPI645	SAE FLANGE 6000 PSI SWEPT 45° - SAE J518		
GMTSEM3	SAE SPLIT FLANGE 3000 PSI - SAE J518		
GMTSEM6	SAE SPLIT FLANGE 6000 PSI - SAE J518		
GMTFLPIR6	SUPERCAT FLANGE		
GMTFLPIR690	SUPERCAT FLANGE SWEPT 90°		
GMTFLPIR645	SUPERCAT FLANGE SWEPT 45°		
GMTFORFS	ORFS FEMALE		INSERTS ORFS
GMTMORFS	ORFS MALE		
GMTC90ORFS	ORFS SWEPT 90° FEMALE		
GMTC45ORFS	ORFS SWEPT 45° FEMALE		
GMTFW	CO2 FEMALE WHITWORTH THREAD	INSERTS WITHWORTH	
GMTMW	CO2 MALE WHITWORTH THREAD		
GMTFMK	PRESSURE WASH FEMALE "K"	WASH CLEANER INSERTS	
GMTGPG	DOUBLE CONNECTOR	DOUBLE CONNECTOR	
GMTRS	WELDING INSERT	WELDING INSERTS	

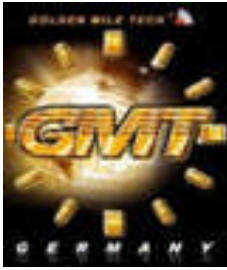

GMTFG

BSP FEMALE, 60° CONE

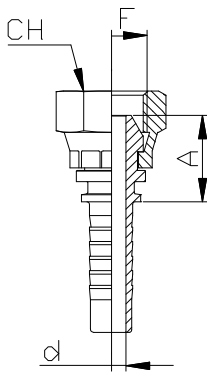

Code article	Thread	øins. Hose		Dimensions (mm)		
		Inch	mm	CH	A	d
GMTFG0203	1/8	3/16	5	15	16,8	3
GMTFG0204	1/8	1/4	6	15	17	4
GMTFG0403	1/4	3/16	5	19	18,6	3
GMTFG0404	1/4	1/4	6	19	18,9	4
GMTFG0405	1/4	5/16	8	19	18,9	5,5
GMTFG0406	1/4	3/8	10	19	19	7
GMTFG0604	3/8	1/4	6	22	20,1	4
GMTFG0605	3/8	5/16	8	22	20,1	5,5
GMTFG0606	3/8	3/8	10	22	20,2	7
GMTFG0608	3/8	1/2	12	22	20,7	7
GMTFG0805	1/2	5/16	8	27	22,3	5,5
GMTFG0806	1/2	3/8	10	27	22,4	7
GMTFG0808	1/2	1/2	12	27	22,9	9,5
GMTFG0810	1/2	5/8	16	27	22,9	12
GMTFG1008	5/8	1/2	12	28	22,9	9,5
GMTFG1010	5/8	5/8	16	28	22,9	12
GMTFG1208	3/4	1/2	12	32	25,4	9,5
GMTFG1210	3/4	5/8	16	32	25,4	12
GMTFG1212	3/4	3/4	20	32	25,6	15
GMTFG1612	1"	3/4	20	38	26,3	15
GMTFG1616	1"	1"	25	38	27,6	20
GMTFG2016	1"1/4	1"	25	50	30	20
GMTFG2020	1"1/4	1"1/4	32	50	30,6	26

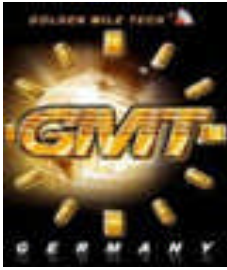

GMTC90G BSP SWEPT 90° FEMALE, 60° CONE

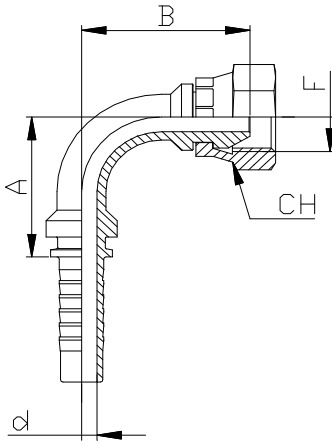

Code article	Thread	øins. Hose		Dimensions (mm)			
		Inch	mm	CH	A	B	d
GMTC90G0203	1/8	3/16	5	15	23	26	3
GMTC90G0204	1/8	1/4	6	15	22	28	4
GMTC90G0403	1/4	3/16	5	19	23	27,5	3
GMTC90G0404	1/4	1/4	6	19	21	30	4
GMTC90G0405	1/4	5/16	8	19	28,5	34	5,5
GMTC90G0406	1/4	3/8	10	19	28,5	34	7
GMTC90G0604	3/8	1/4	6	22	26	32	4
GMTC90G0605	3/8	5/16	8	22	32	38	5,5
GMTC90G0606	3/8	3/8	10	22	34	38	7
GMTC90G0608	3/8	1/2	12	22	42	39	7
GMTC90G0805	1/2	5/16	8	27	33	41	5,5
GMTC90G0806	1/2	3/8	10	27	35	42	7
GMTC90G0808	1/2	1/2	12	27	40	44	9,5
GMTC90G0810	1/2	5/8	16	27	43	47	12
GMTC90G1008	5/8	1/2	12	28	40	45	9,5
GMTC90G1010	5/8	5/8	16	28	51	50	12
GMTC90G1208	3/4	1/2	12	32	39	50	9,5
GMTC90G1210	3/4	5/8	16	32	52	54	12
GMTC90G1212	3/4	3/4	20	32	56	59	15
GMTC90G1612	1"	3/4	20	38	57	63	15
GMTC90G1616	1"	1"	25	38	76	69	20
GMTC90G2016	1"1/4	1"	25	50	72	79	20
GMTC90G2020	1"1/4	1"1/4	32	50	87	89	26



GMTC45G BSP SWEPT 45° FEMALE, 60° CONE

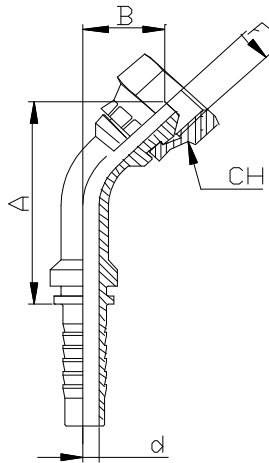

Code article	Thread	øins. Hose		Dimensions (mm)			
		Inch	mm	CH	A	B	d
GMTC45G0203	1/8	3/16	5	15	38	16	3
GMTC45G0204	1/8	1/4	6	15	42	20	4
GMTC45G0403	1/4	3/16	5	19	40	20	3
GMTC45G0404	1/4	1/4	6	19	40	16	4
GMTC45G0405	1/4	5/16	8	19	40	20	5,5
GMTC45G0406	1/4	3/8	10	19	42	20	7
GMTC45G0604	3/8	1/4	6	22	40	18	4
GMTC45G0605	3/8	5/16	8	22	51	19	5,5
GMTC45G0606	3/8	3/8	10	22	56	19	7
GMTC45G0608	3/8	1/2	12	22	62	23	7
GMTC45G0805	1/2	5/16	8	27	48	25	5,5
GMTC45G0806	1/2	3/8	10	27	50	19,5	7
GMTC45G0808	1/2	1/2	12	27	65	25	9,5
GMTC45G0810	1/2	5/8	16	27	55	31	12
GMTC45G1008	5/8	1/2	12	28	61	31	9,5
GMTC45G1010	5/8	5/8	16	28	63	31	12
GMTC45G1208	3/4	1/2	12	32	68	29	9,5
GMTC45G1210	3/4	5/8	16	32	68	29	12
GMTC45G1212	3/4	3/4	20	32	64	30	15
GMTC45G1612	1"	3/4	20	38	64	35	15
GMTC45G1616	1"	1"	25	38	88	35	20
GMTC45G2016	1"1/4	1"	25	50	91	43	20
GMTC45G2020	1"1/4	1"1/4	32	50	105	50	26

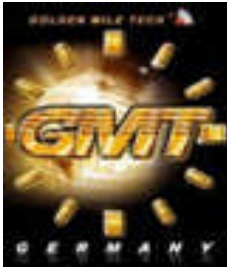

GMTC90C

BSP FEMALE 90° COMPACT ELBOW, 60° CONE

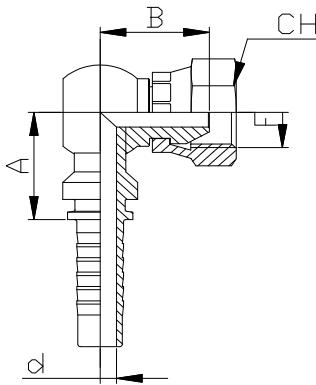

Code article	Thread	øins. Hose		Dimensions (mm)			
		Inch	mm	CH	A	B	d
GMTC90COMP04	1/4	1/4	6	19	17,6	19	4
GMTC90COMP06	3/8	5/16	8	22	20,4	22	5,5
GMTC90COMP06	3/8	3/8	10	22	21,3	24	7
GMTC90COMP08	1/2	1/2	12	27	24,1	25	9,5
GMTC90COMP12	3/4	3/4	20	32	27,2	34	15
GMTC90COMP16	1"	1"	25	38	33,5	39	20

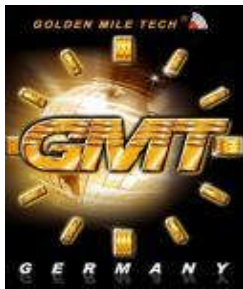

GMTFSPG

BSP FEMALE FLAT FACE

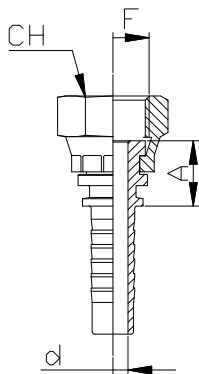

Code article	Thread	øins. Hose		Dimensions (mm)		
		Inch	mm	CH	A	d
GMTFSPG0404	1/4	1/4	6	19	14,3	4
GMTFSPG0606	3/8	3/8	10	22	15,3	7
GMTFSPG0806	1/2	3/8	10	27	16,7	7
GMTFSPG0808	1/2	1/2	12	27	17,2	9,5
GMTFSPG1208	3/4	1/2	12	32	20,2	9,5
GMTFSPG1210	3/4	5/8	16	32	20,2	12
GMTFSPG1212	3/4	3/4	20	32	20,4	15
GMTFSPG1616	1"	1"	25	38	21,2	20



GMTOG

BSP BANJO

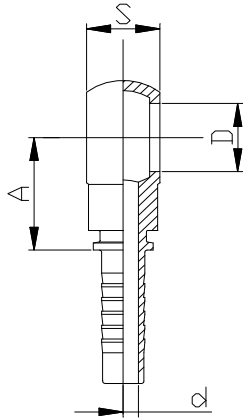

Code article	Banjo Bolt	øins. Hose		Dimensions (mm)		
		Inch	mm	A	S	d
GMTOG0203	1/8	3/16	5	20,3	10	3
GMTOG0204	1/8	1/4	6	20,6	10	4
GMTOG0403	1/4	3/16	5	26,1	13,8	3
GMTOG0404	1/4	1/4	6	23,1	13,8	4
GMTOG0405	1/4	5/16	8	25,1	13,8	5,5
GMTOG0406	1/4	3/8	10	31,9	13,8	7
GMTOG0604	3/8	1/4	6	27,5	17	4
GMTOG0605	3/8	5/16	8	27,5	17	5,5
GMTOG0606	3/8	3/8	10	27,6	17	7
GMTOG0608	3/8	1/2	12	32,1	17	9,5
GMTOG0805	1/2	5/16	8	27,2	22	5,5
GMTOG0806	1/2	3/8	10	27,8	22	7
GMTOG0808	1/2	1/2	12	34,7	22	9,5
GMTOG0810	1/2	5/8	16	34,7	23,3	12
GMTOG1008	5/8	1/2	12	39,8	23	9,5
GMTOG1010	5/8	5/8	16	41,3	23	12
GMTOG1208	3/4	1/2	12	34,6	30	9,5
GMTOG1210	3/4	5/8	16	35,3	30	12
GMTOG1212	3/4	3/4	20	35,7	30	15
GMTOG1612	1"	3/4	20	51,5	38	15
GMTOG1616	1"	1"	25	43,9	38	20
GMTOG2016	1"1/4	1"	25			
GMTOG2020	1"1/4	1"1/4	32	53	42	26
GMTOG2420	1"1/2	1"1/4	32			
GMTOG2424	1"1/2	1"1/2	40			
GMTOG3224	2"	1"1/2	40			
GMTOG3232	2"	2"	50			



GMTMG

BSPP MALE, 60° SEAT

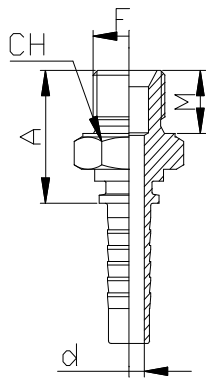

Code article	Thread	øins. Hose		Dimensions (mm)			
		Inch	mm	CH	A	M	d
GMTMG0203	1/8	3/16	5	15	21,6	9,6	3
GMTMG0204	1/8	1/4	6	15	21,9	9,6	4
GMTMG0403	1/4	3/16	5	19	24,5	11,2	3
GMTMG0404	1/4	1/4	6	19	24,8	11,2	4
GMTMG0405	1/4	5/16	8	19	25	11,2	5,5
GMTMG0406	1/4	3/8	10	19	25,1	11,2	7
GMTMG0604	3/8	1/4	6	22	28,3	13,6	4
GMTMG0605	3/8	5/16	8	22	28,5	13,6	5,5
GMTMG0606	3/8	3/8	10	22	28,6	13,6	7
GMTMG0608	3/8	1/2	12	22	29,1	13,6	7
GMTMG0804	1/2	1/4	6	22	30,8	14,8	4
GMTMG0805	1/2	5/16	8	27	30,8	14,8	5,5
GMTMG0806	1/2	3/8	10	27	30,9	14,8	7
GMTMG0808	1/2	1/2	12	27	31,4	14,8	9,5
GMTMG0810	1/2	5/8	16	27	31,4	14,8	12
GMTMG1008	5/8	1/2	12	28	33	16	9,5
GMTMG1010	5/8	5/8	16	28	35	16	12
GMTMG1208	3/4	1/2	12	32	34,7	17	9,5
GMTMG1210	3/4	5/8	16	32	34,7	17	12
GMTMG1212	3/4	3/4	20	32	35,1	17	15
GMTMG1610	1"	5/8	16	41	38,6	20,3	12
GMTMG1612	1"	3/4	20	41	39,8	20,3	15
GMTMG1616	1"	1"	25	41	41,1	20,3	20
GMTMG2016	1"1/4	1"	25	50	46,3	22	20
GMTMG2020	1"1/4	1"1/4	32	50	46,9	22	26
GMTMG2420	1"1/2	1"1/4	32	55	47,2	22	26
GMTMG2424	1"1/2	1"1/2	40	55	48,1	22	32
GMTMG3224	2"	1"1/2	40	70	51,3	24	32
GMTMG3232	2"	2"	50	70	51,3	24	44



GMTMC

BSPT MALE, 60° SEAT

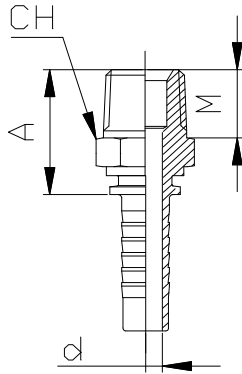

Code article	Thread	øins. Hose		Dimensions (mm)			
		Inch	mm	CH	A	M	d
GMTMC0203	1/8	42430	5	12	21,9	10	3
GMTMC0204	1/8	1/4	6	12	22,2	10	4
GMTMC0403	1/4	3/16	5	15	27	14	3
GMTMC0404	1/4	1/4	6	15	27	14	4
GMTMC0405	1/4	5/16	8	15	27	14	5,5
GMTMC0406	1/4	3/8	10	15	27,1	14	7
GMTMC0604	3/8	1/4	6	19	28,5	14,5	4
GMTMC0605	3/8	5/16	8	19	28,7	14,5	5,5
GMTMC0606	3/8	3/8	10	19	28,8	14,5	7
GMTMC0608	3/8	1/2	12	19	29,3	14,5	7
GMTMC0805	1/2	5/16	8				
GMTMC0806	1/2	3/8	10	22	34,3	19	7
GMTMC0808	1/2	1/2	12	22	34,8	19	9,5
GMTMC0810	1/2	5/8	16				
GMTMC1008	5/8	1/2	12				
GMTMC1010	5/8	5/8	16				
GMTMC1208	3/4	1/2	12	27	35,8	19	9,5
GMTMC1210	3/4	5/8	16	27	35,8	19	12
GMTMC1212	3/4	3/4	20	27	36,5	19	15
GMTMC1610	1"	5/8	16				
GMTMC1612	1"	3/4	20	36	42,5	24	15
GMTMC1616	1"	1"	25	36	43,8	24	20
GMTMC2016	1"1/4	1"	25	46	47,8	24,5	20
GMTMC2020	1"1/4	1"1/4	32	46	48,4	24,5	26
GMTMC2420	1"1/2	1"1/4	32	50	49,2	25	26
GMTMC2424	1"1/2	1"1/2	40	50	50,1	25	32
GMTMC3224	2"	1"1/2	40				
GMTMC3232	2"	2"	50	65	52,3	26	44

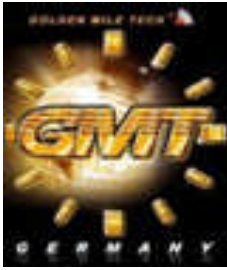

GMTPFG

BSP FEMALE THRUST WIRE NUT, 60° CONE

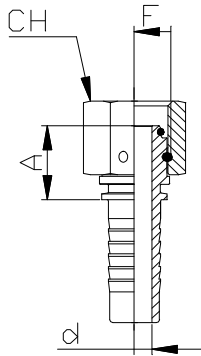

Code article	Thread	øins. Hose		Dimensions (mm)			
		Inch	mm	CH	A	d	
GMTPFG1210	F	3/4	0,625	16	32	25	12
GMTPFG1212	F	3/4	3/4	20	32	26	15
GMTPFG1612	F	1"	3/4	20	38	27	15
GMTPFG1616	F	1"	1"	25	38	28	20
GMTPFG2016	F	1"1/4	1"	25	50	30	20
GMTPFG2020*	F	1"1/4	1"1/4	32	50	32	26
GMTPFG2420*	F	1"1/2	1"1/4	32	55	34	26
GMTPFG2424*	F	1"1/2	1"1/2	40	55	34,4	32
GMTPFG3224*	F	2"	1"1/2	40	70	31	32
GMTPFG3232*	F	2"	2"	50	70	31	44

* WITH O-RING

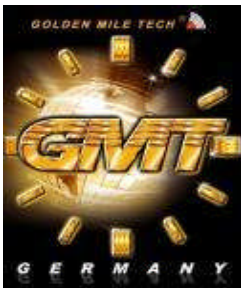

GMTSFG

BSP FEMALE SLIP BACK NUT, 60° CONE

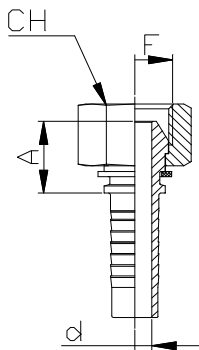

Code article	Thread	øins. Hose		Dimensions (mm)			
		Inch	mm	CH	A	d	
GMTSFG0404	F	1/4	0,25	6	19	18,9	4
GMTSFG0604	F	3/8	1/4	6	22	20,1	4
GMTSFG0605	F	3/8	5/16	8	22	20,1	5,5
GMTSFG0606	F	3/8	0,375	10	22	20,2	7
GMTSFG0806	F	1/2	0,375	10	27	22,4	7
GMTSFG0808	F	1/2	0,5	12	27	22,9	9,5

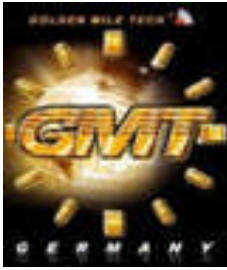

GMTPC90

BSP SWEPT 90° FEMALE THRUST WIRE NUT, 60° CONE

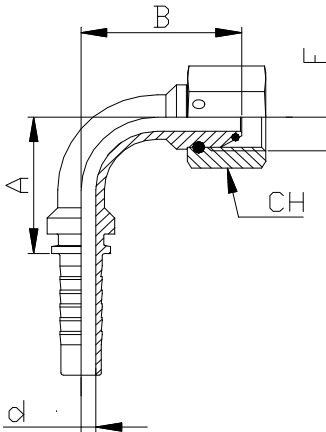

Code article	Thread	øins. Hose		Dimensions (mm)			
		Inch	mm	CH	A	B	d
GMTPC90G1210	3/4	0,625	16	32	45	49	12
GMTPC90G1212	3/4	3/4	20	32	56	56	15
GMTPC90G1612	1"	3/4	20	38	56	59	15
GMTPC90G1616	1"	1"	25	38	70	67	20
GMTPC90G2016	1"1/4	1"	25	50	72	79	20
GMTPC90G2020*	1"1/4	1"1/4	32	50	85	86	26
GMTPC90G2420*	1"1/2	1"1/4	32	55	85	93	26
GMTPC90G2424*	1"1/2	1"1/2	40	55	99	100	32
GMTPC90G3224*	2"	1"1/2	40	70	99	125	32
GMTPC90G3232*	2"	2"	50	70	125	132	44

* WITH O-RING

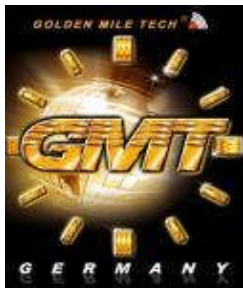

GMTSC90

BSP SWEPT 90° FEMALE SLIP BACK NUT, 60° CONE

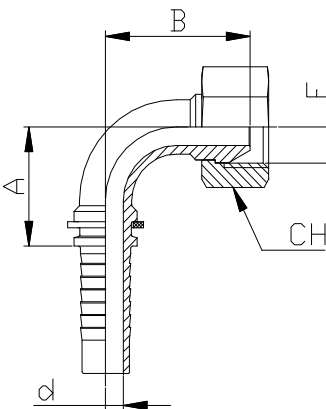

Code article	Thread	øins. Hose		Dimensions (mm)			
		Inch	mm	CH	A	B	d
GMTSC90G0404	1/4	0,25	6	19	21	30	4
GMTSC90G0604	3/8	1/4	6	22	26	32	4
GMTSC90G0605	3/8	5/16	8	22	32	38	5,5
GMTSC90G0606	3/8	0,375	10	22	34	38	7
GMTSC90G0806	1/2	0,375	10	27	35	42	7
GMTSC90G0808	1/2	0,5	12	27	40	44	9,5

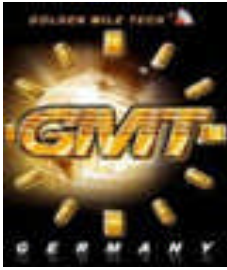

GMTFJ

JIC FEMALE, 37° SEAT

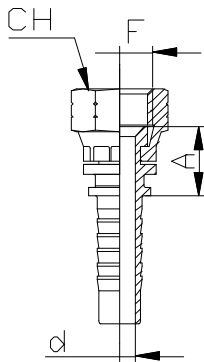

Code article	Thread	øins. Hose		Dimensions (mm)		
		Inch	mm	CH	A	d
	F					
GMTFJ0603	7/16-20	3/16	5	15	15,1	3
GMTFJ0604	7/16-20	1/4	6	15	15,4	4
GMTFJ0804	1/2-20	1/4	6	17	14,9	4
GMTFJ0805	1/2-20	5/16	8	17	14,9	5,5
GMTFJ1004	9/16-18	1/4	6	19	16,3	4
GMTFJ1005	9/16-18	5/16	8	19	16,3	5,5
GMTFJ1006	9/16-18	3/8	10	19	16,4	7
GMTFJ1106	5/8-18	3/8	10	22	17,3	7
GMTFJ1205	3/4-16	5/16	8	24	16,8	5,5
GMTFJ1206	3/4-16	3/8	10	24	16,9	7
GMTFJ1208	3/4-16	1/2	12	24	17,4	9,5
GMTFJ1606	7/8-14	3/8	10	27	19	7
GMTFJ1608	7/8-14	1/2	12	27	19,5	9,5
GMTFJ1610	7/8-14	5/8	16	27	19,5	12
GMTFJ2008	1"1/16-12	1/2	12	32	23,3	9,5
GMTFJ2010	1"1/16-12	5/8	16	32	23,3	12
GMTFJ2012	1"1/16-12	3/4	20	32	23,5	15
GMTFJ2212	1"3/16-12	3/4	20	36	22	15
GMTFJ2512	1"5/16-12	3/4	20	41	24,7	15
GMTFJ2516	1"5/16-12	1"	25	41	26	20
GMTFJ3416	1"5/8-12	1"	25	50	28,7	20
GMTFJ3420	1"5/8-12	1"1/4	32	50	29,3	26



GMTC90J JIC SWEPT 90° FEMALE, 37° SEAT

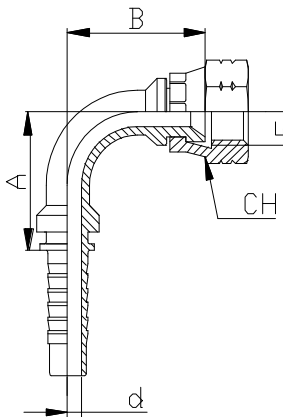

Code article	Thread	øins. Hose		Dimensions (mm)			
		Inch	mm	CH	A	B	d
	F						
GMTC90J0603	7/16-20	3/16	5	15	22	22	3
GMTC90J0604	7/16-20	1/4	6	15	23	24	4
GMTC90J0804	1/2-20	1/4	6	17	23	25	4
GMTC90J0805	1/2-20	5/16	8	17	30	29	5,5
GMTC90J1004	9/16-18	1/4	6	19	23	27	4
GMTC90J1005	9/16-18	5/16	8	19	32	30	5,5
GMTC90J1006	9/16-18	3/8	10	19	32	33	7
GMTC90J1106	5/8-18	3/8	10	22	33	37	7
GMTC90J1205	3/4-16	5/16	8	24	32	37	5,5
GMTC90J1206	3/4-16	3/8	10	24	32	35	7
GMTC90J1208	3/4-16	1/2	12	24	40	40	9,5
GMTC90J1606	7/8-14	3/8	10	27	32	35	7
GMTC90J1608	7/8-14	1/2	12	27	42	42	9,5
GMTC90J1610	7/8-14	5/8	16	27	49	49	12
GMTC90J2008	1"1/16-12	1/2	12	32	40	48	9,5
GMTC90J2010	1"1/16-12	5/8	16	32	52	53	12
GMTC90J2012	1"1/16-12	3/4	20	32	57	55	15
GMTC90J2212	1"3/16-12	3/4	20	36	58	64	15
GMTC90J2512	1"5/16-12	3/4	20	41	60	59	15
GMTC90J2516	1"5/16-12	1"	25	41	75	68	20
GMTC90J3416	1"5/8-12	1"	25	50	75	73	20
GMTC90J3420	1"5/8-12	1"1/4	32	50	89	83	26



GMTC90C

JIC FEMALE 90° COMPACT ELBOW, 37° SEAT

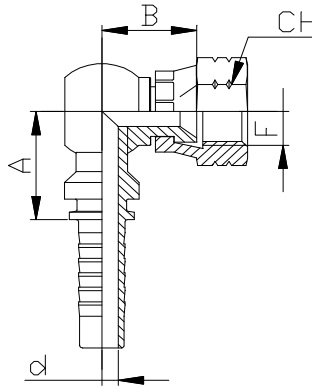

Code article	Thread	øins. Hose		Dimensions (mm)			
		Inch	mm	CH	A	B	d
	F						
GMTC90COMPJ0604	7/16-20	1/4	6	15	14	20	4
GMTC90COMPJ0804	1/2-20	1/4	6	17	14	21	4
GMTC90COMPJ1004	9/16-18	1/4	6	19	15	24	4
GMTC90COMPJ1005	9/16-18	5/16	8	19	15	24	5,5
GMTC90COMPJ1006	9/16-18	3/8	10	19	18	24	7
GMTC90COMPJ1206	3/4-16	3/8	10	24	20	23	7
GMTC90COMPJ1208	3/4-16	1/2	12	24	21	23	9,5
GMTC90COMPJ1608	7/8-14	1/2	12	27	21	23	9,5
GMTC90COMPJ1610	7/8-14	5/8	16	27	23	27	12
GMTC90COMPJ2010	1"1/16-12	5/8	16	32	23	29	12
GMTC90COMPJ2012	1"1/16-12	3/4	20	32	27	31	15
GMTC90COMPJ2516	1"5/16-12	1"	25	41	35	37	20

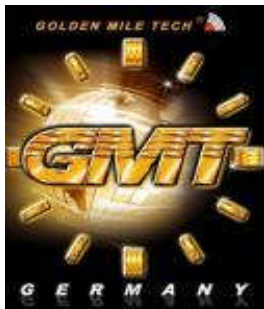

GMTSFJ

JIC FEMALE SLIP BACK NUT, 37° SEAT

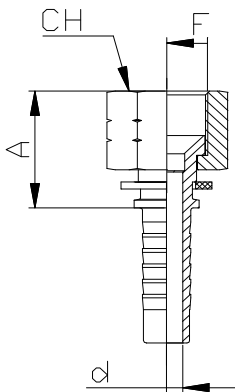

Code article	Thread	øins. Hose		Dimensions (mm)		
		Inch	mm	CH	A	d
	F					
GMTSFJ1004	9/16-18	1/4	6	19	16,3	4
GMTSFJ1206	3/4-16	3/8	10	24	16,9	7
GMTSFJ1606	7/8-14	3/8	10	27	19	7
GMTSFJ1608	7/8-14	1/2	12	27	19,5	9,5

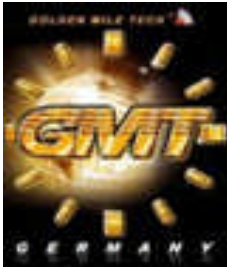

GMTC45J JIC SWEPT 45° FEMALE, 37° SEAT

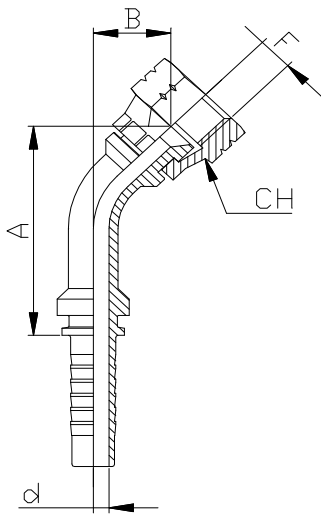

Code article	Thread	øins. Hose		Dimensions (mm)			
		Inch	mm	CH	A	B	d
	F						
GMTC45J0603	7/16-20	3/16	5	15	38	16	3
GMTC45J0604	7/16-20	1/4	6	15	36	12	4
GMTC45J0804	1/2-20	1/4	6	17	36	13	4
GMTC45J0805	1/2-20	5/16	8	17	36	16	5,5
GMTC45J1004	9/16-18	1/4	6	19	37	13	4
GMTC45J1005	9/16-18	5/16	8	19	48	15	5,5
GMTC45J1006	9/16-18	3/8	10	19	51	15	7
GMTC45J1106	5/8-18	3/8	10	22	51	18	7
GMTC45J1205	3/4-16	5/16	8	24	54	20	5,5
GMTC45J1206	3/4-16	3/8	10	24	41	18	7
GMTC45J1208	3/4-16	1/2	12	24	63	20	9,5
GMTC45J1606	7/8-14	3/8	10	27	54	20	7
GMTC45J1608	7/8-14	1/2	12	27	69	21	9,5
GMTC45J1610	7/8-14	5/8	16	27	78	25	12
GMTC45J2008	1"1/16-12	1/2	12	32	66	29	9,5
GMTC45J2010	1"1/16-12	5/8	16	32	61	24	12
GMTC45J2012	1"1/16-12	3/4	20	32	62	27	15
GMTC45J2212	1"3/16-12	3/4	20	36	65	35	15
GMTC45J2512	1"5/16-12	3/4	20	41	67	29	15
GMTC45J2516	1"5/16-12	1"	25	41	87	32	20
GMTC45J3416	1"5/8-12	1"	25	50	91	35	20
GMTC45J3420	1"5/8-12	1"1/4	32	50	101	43	26



GMTMJ

JIC MALE, 37° CONE

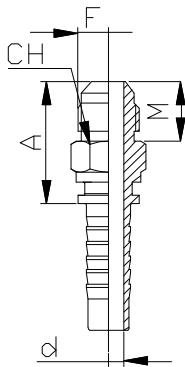

Code article	Thread	øins. Hose		Dimensions (mm)			
		Inch	mm	CH	A	M	d
	F						
GMTMJ0603	7/16-20	3/16	5	12	26,5	14,1	3
GMTMJ0604	7/16-20	1/4	6	12	26,8	14,1	4
GMTMJ0804	1/2-20	1/4	6	15	28,1	14,1	4
GMTMJ0805	1/2-20	5/16	8	15	28,3	14,1	5,5
GMTMJ1004	9/16-18	1/4	6	15	28,3	14,1	4
GMTMJ1005	9/16-18	5/16	8	15	28,5	14,1	5,5
GMTMJ1006	9/16-18	3/8	10	15	28,6	14,1	7
GMTMJ1106	5/8-18	3/8	10	17	29	16	7
GMTMJ1204	3/4-16	1/4	10	19	31,2	17,2	4
GMTMJ1205	3/4-16	5/16	8	19	31,4	17,2	5,5
GMTMJ1206	3/4-16	3/8	10	19	31,5	17,2	7
GMTMJ1208	3/4-16	1/2	12	19	32	17,2	9,5
GMTMJ1606	7/8-14	3/8	10	24	34,8	19,5	7
GMTMJ1608	7/8-14	1/2	12	24	35,3	19,5	9,5
GMTMJ1610	7/8-14	5/8	16	24	35,3	19,5	12
GMTMJ2008	1"1/16-12	1/2	12	27	39,4	21,9	9,5
GMTMJ2010	1"1/16-12	5/8	16	27	39,4	21,9	12
GMTMJ2012	1"1/16-12	3/4	20	27	40,1	21,9	15
GMTMJ2016	1"1/16-12	1"	25	32	41,1	21,9	20
GMTMJ2212	1"3/16-12	3/4	20	32	41,5	22,5	15
GMTMJ2512	1"5/16-12	3/4	20	34	42	23	15
GMTMJ2516	1"5/16-12	1"	25	34	42,8	23	20
GMTMJ3416	1"5/8-12	1"	25	42	46	24,3	20
GMTMJ3420	1"5/8-12	1"1/4	32	42	46,5	24,3	26
GMTMJ4020	1"7/8-12	1"1/4	32	50	51,8	27,5	26
GMTMJ4024	1"7/8-12	1"1/2	40	50	52	27,5	32
GMTMJ5032	2"1/2-12	2"	50	65	62	34	45

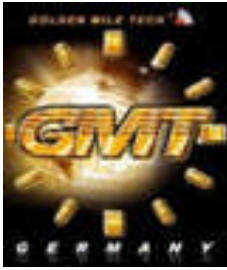

GMTPFJ

JIC FEMALE THRUST WIRE NUT, 37° SEAT

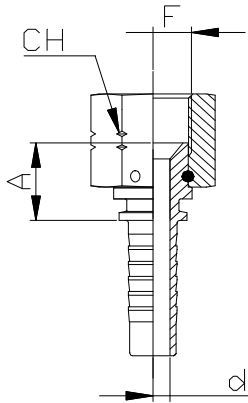

Code article	Thread	øins. Hose		Dimensions (mm)		
		Inch	mm	CH	A	d
GMTPFJ2010	1"1/16-12	0,625	16	32	21	12
GMTPFJ2012	1"1/16-12	3/4	20	32	21	15
GMTPFJ2512	1"5/16-12	3/4	20	41	24	15
GMTPFJ2516	1"5/16-12	1"	25	41	25	20
GMTPFJ3416	1"5/8-12	1"	25	50	27	20
GMTPFJ3420	1"5/8-12	1"1/4	32	50	28	26
GMTPFJ4020	1"7/8-12	1"1/4	32	55	31	26
GMTPFJ4024	1"7/8-12	1"1/2	40	55	31	32
GMTPFJ5032	2"1/2-12	2"	50	70	31	44

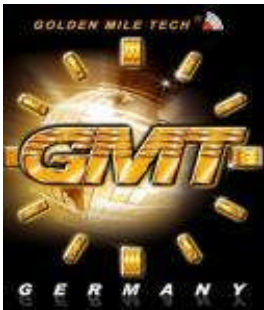

GMTFJDE

JIC FEMALE DOUBLE HEXAGON, 37° SEAT

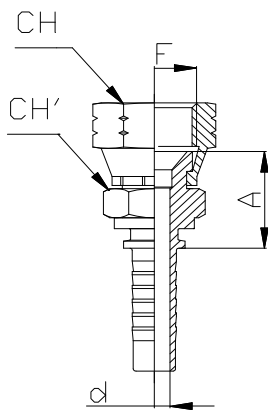

Code article	Thread	øins. Hose		Dimensions (mm)			
		Inch	mm	CH	CH'	A	d
GMTFJDE0604	7/16-20	1/4	6	15	14	21,5	4
GMTFJDE0804	1/2-20	1/4	6	17	17	21,5	4
GMTFJDE1004	9/16-18	1/4	6	19	17	21,5	4
GMTFJDE1005	9/16-18	5/16	8	19	17	21,5	5,5
GMTFJDE1006	9/16-18	3/8	10	19	19	20	7
GMTFJDE1206	3/4-16	3/8	10	24	19	20	7
GMTFJDE1208	3/4-16	1/2	12	24	22	27	9,5
GMTFJDE1608	7/8-14	1/2	12	27	22	27	9,5
GMTFJDE2012	1"1/16-12	3/4	20	32	27	34	15
GMTFJDE2516	1"5/16-12	1"	25	41	32	35	20

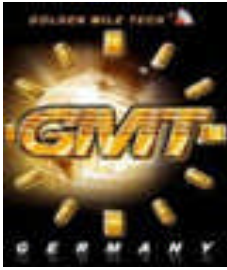

GMTFORF

ORFS FEMALE

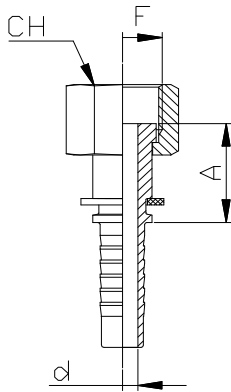

Code article	Thread	øins. Hose		Dimensions (mm)		
		Inch	mm	CH	A	d
	F					
GMTFORFS1004	9/16-18	1/4	6	17	21,3	4
GMTFORFS1104	11/16-16	1/4	6	22	23,6	4
GMTFORFS1105	11/16-16	5/16	8	22	23,6	5,5
GMTFORFS1106	11/16-16	3/8	10	22	23,7	7
GMTFORFS1306	13/16-16	3/8	10	24	27,2	7
GMTFORFS1308	13/16-16	1/2	12	24	27,7	9,5
GMTFORFS1808	1"-14	1/2	12	30	30,3	9,5
GMTFORFS1810	1"-14	5/8	16	30	30,3	12
GMTFORFS2208	1"3/16-12	1/2	12	36	32,8	9,5
GMTFORFS2210	1"3/16-12	5/8	16	36	32,8	12
GMTFORFS2212	1"3/16-12	3/4	20	36	33	15
GMTFORFS2612	1"7/16-12	3/4	20	41	33,5	15
GMTFORFS2616	1"7/16-12	1"	25	41	34,8	20
GMTFORFS3620	1"11/16-12	1"1/4	32	50	35,3	26
GMTFORFS4624	2"-12	1"1/2	40	60	51,5	32



GMTC450

ORFS SWEPT 45° FEMALE

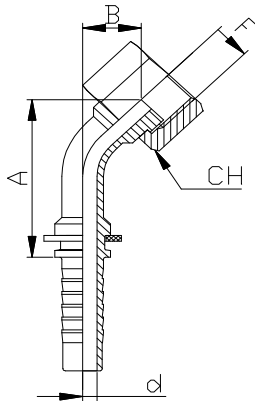

Code article	Thread	øins. Hose		Dimensions (mm)			
		Inch	mm	CH	A	B	d
GMTC45ORFS1004	F 9/16-18	1/4	6	17	44	11	4
GMTC45ORFS1104	11/16-16	1/4	6	22	44	11	4
GMTC45ORFS1105	11/16-16	5/16	8	22	45	11	5,5
GMTC45ORFS1106	11/16-16	3/8	10	22	51	11	7
GMTC45ORFS1306	13/16-16	3/8	10	24	55	13	7
GMTC45ORFS1308	13/16-16	1/2	12	24	60	14	9,5
GMTC45ORFS1808	1"-14	1/2	12	30	62	15	9,5
GMTC45ORFS1810	1"-14	5/8	16	30	74	19	12
GMTC45ORFS2208	1"3/16-12	1/2	12	36	62	24	9,5
GMTC45ORFS2210	1"3/16-12	5/8	16	36	75	23	12
GMTC45ORFS2212	1"3/16-12	3/4	20	36	88	29	15
GMTC45ORFS2612	1"7/16-12	3/4	20	41	86	32	15
GMTC45ORFS2616	1"7/16-12	1"	25	41	97	32	20
GMTC45ORFS3620	1"11/16-12		32	50	107	35	26
GMTC45ORFS4624	2"-12	1"1/2	40	60	140	45	32

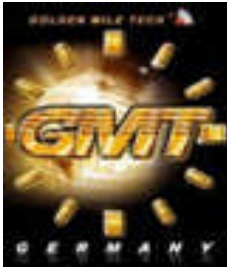

GMTMORF

ORFS MALE

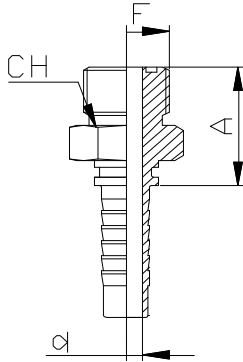

Code article	Thread	øins. Hose		Dimensions (mm)		
		Inch	mm	CH	A	d
	F					
GMTMORFS1004	9/16-18	1/4	6	17	27	4
GMTMORFS1104	11/16-16	1/4	6	19	28,2	4
GMTMORFS1105	11/16-16	5/16	8	19	28,2	5,5
GMTMORFS1106	11/16-16	3/8	10	19	28,3	7
GMTMORFS1306	13/16-16	3/8	10	22	31,3	7
GMTMORFS1308	13/16-16	1/2	12	22	31,8	9,5
GMTMORFS1808	1"-14	1/2	12	27	37,3	9,5
GMTMORFS1810	1"-14	5/8	16	27	37,3	12
GMTMORFS1812	1"-14	3/4	20	27	37,5	15
GMTMORFS2208	1"3/16-12	1/2	12	32	39,8	9,5
GMTMORFS2210	1"3/16-12	5/8	16	32	40,3	12
GMTMORFS2212	1"3/16-12	3/4	20	32	40,5	15
GMTMORFS2612	1"7/16-12	3/4	20	41	45	15
GMTMORFS2616	1"7/16-12	1"	25	41	46,3	20
GMTMORFS3620	1"11/16-12		32	46	48,9	26
GMTMORFS4624	2"-12	1"1/2	40	55	53,8	32



GMTC900

ORFS SWEPT 90° FEMALE

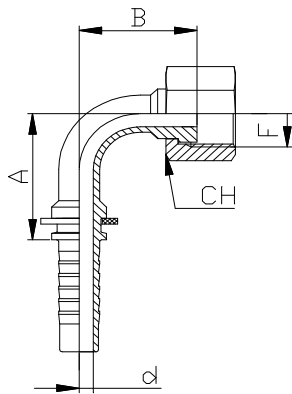

Code article	Thread	øins. Hose		Dimensions (mm)			
		Inch	mm	CH	A	B	d
GMTC90ORFS1004	F 9/16-18	1/4	6	17	29	26	4
GMTC90ORFS1104	11/16-16	1/4	6	22	29	28	4
GMTC90ORFS1105	11/16-16	5/16	8	22	30	28	5,5
GMTC90ORFS1106	11/16-16	3/8	10	22	35	29	7
GMTC90ORFS1306	13/16-16	3/8	10	24	35	32	7
GMTC90ORFS1308	13/16-16	1/2	12	24	39	37	9,5
GMTC90ORFS1808	1"-14	1/2	12	30	40	37	9,5
GMTC90ORFS1810	1"-14	5/8	16	30	54	44	12
GMTC90ORFS2208	1"3/16-12	1/2	12	36	41	42	9,5
GMTC90ORFS2210	1"3/16-12	5/8	16	36	45	47	12
GMTC90ORFS2212	1"3/16-12	3/4	20	36	51	53	15
GMTC90ORFS2612	1"7/16-12	3/4	20	41	58	54	15
GMTC90ORFS2616	1"7/16-12	1"	25	41	74	68	20
GMTC90ORFS3620	1"11/16-12	1"1/4	32	50	90	74	26
GMTC90ORFS4624	2"-12	1"1/2	40	60	108	95	32

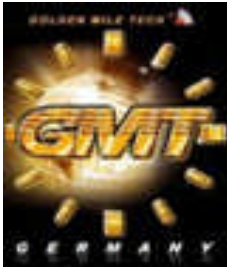

GMTMEL

METRIC MALE, 24° SEAT, DIN 3853 LIGHT

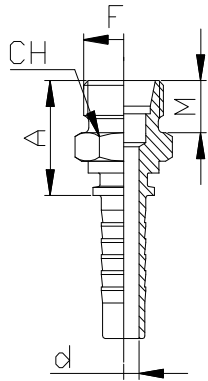

CEL

Code article	Thread	Standpipe	øins. Hose		Dimensions (mm)			
			mm	Inch	mm	CH	A	M
GMTMEL0603	M12x1,5	6	3/16	5	12	20,7	10	3
GMTMEL0604	M12x1,5	6	1/4	6	12	21	10	4
GMTMEL0804	M14x1,5	8	1/4	6	14	22	10	4
GMTMEL1004	M16x1,5	10	1/4	6	17	23	11	4
GMTMEL1005	M16x1,5	10	5/16	8	17	23,2	11	5,5
GMTMEL1006	M16x1,5	10	3/8	10	17	23,3	11	7
GMTMEL1204	M18x1,5	12	1/4	6	19	24	11	4
GMTMEL1205	M18x1,5	12	5/16	8	19	24,2	11	5,5
GMTMEL1206	M18x1,5	12	3/8	10	19	24,3	11	7
GMTMEL1506	M22x1,5	15	3/8	10	24	25,3	12	7
GMTMEL1508	M22x1,5	15	1/2	12	24	25,8	12	9,5
GMTMEL1808	M26x1,5	18	0,5	12	27	26,8	12	9,5
GMTMEL1810	M26x1,5	18	5/8	16	27	26,8	12	12
GMTMEL1812	M26x1,5	18	0,75	20	27	27,5	12	15
GMTMEL2212	M30x2	22	0,75	20	32	29,5	14	15
GMTMEL2816	M36x2	28	1"	25	41	31,8	14	20
GMTMEL3520	M45x2	35	1"1/4	32	46	40	16	26
GMTMEL4224	M52x2	42	1"1/2	40	55	42,6	16	32

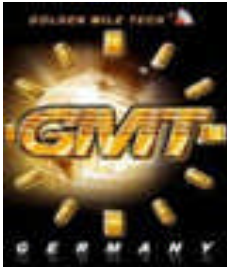

GMTC45ES

METRIC SWIPT 45° O-RING FEMALE, 24° CONE, DIN 3865 HEAVY

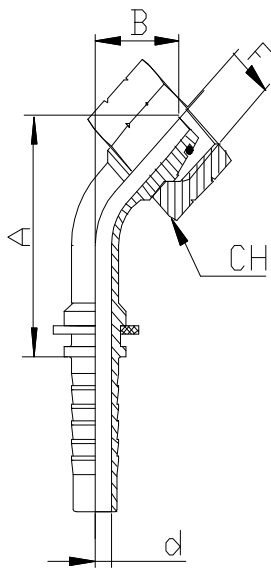

DKOL45

Code article	Thread	Standp ipe mm	øins. Hose		Dimensions (mm)			
			Inch	mm	CH	A	B	d
GMTC45ES0603	M14x1,5	6	3/16	5	17	36	15	3
GMTC45ES0604*	M14x1,5	6	1/4	6	17	38	16	4
GMTC45ES0804	M16x1,5	8	1/4	6	19	38	16	4
GMTC45ES1004	M18x1,5	10	1/4	6	22	38	17	4
GMTC45ES1005	M18x1,5	10	5/16	8	22	44	17	5,5
GMTC45ES1006*	M18x1,5	10	3/8	10	22	60	21	7
GMTC45ES1204	M20x1,5	12	1/4	6	24	40	18	4
GMTC45ES1205	M20x1,5	12	5/16	8	24	46	19	5,5
GMTC45ES1206	M20x1,5	12	3/8	10	24	47	18	7
GMTC45ES1406	M22x1,5	14	3/8	10	27	49	20	7
GMTC45ES1608	M24x1,5	16	1/2	12	30	57	21	9,5
GMTC45ES2010	M30x2	20	5/8	16	36	70	27	12
GMTC45ES2012	M30x2	20	0,75	20	36	70	29	15
GMTC45ES2512	M36x2	25	0,75	20	46	70	29	15
GMTC45ES2516	M36x2	25	1"	25	46	82	33	20
GMTC45ES3016	M42x2	30	1"	25	50	82	33	20
GMTC45ES3820	M52x2	38	1"1/4	32	60	99	40	26

* CRIMPED NUT

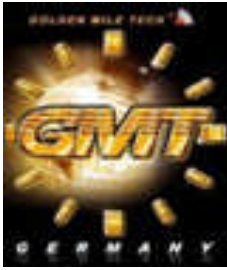

GMTC90ES

METRIC SWIPT 90° O-RING FEMALE, 24° CONE, DIN 3865 HEAVY

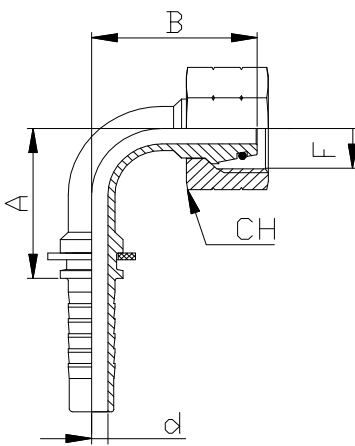

DKOS90

Code article	Thread	Standpipe	øins. Hose		Dimensions (mm)			
			Inch	mm	CH	A	B	d
GMTC90ES0603	M14x1,5	6	3/16	5	17	21	28	3
GMTC90ES0604*	M14x1,5	6	1/4	6	17	24	32	4
GMTC90ES0804	M16x1,5	8	1/4	6	19	26	28	4
GMTC90ES1004	M18x1,5	10	1/4	6	22	28	30	4
GMTC90ES1005	M18x1,5	10	5/16	8	22	31	33	5,5
GMTC90ES1006*	M18x1,5	10	3/8	10	22	31	43	7
GMTC90ES1204	M20x1,5	12	1/4	6	24	24	31	4
GMTC90ES1205	M20x1,5	12	5/16	8	24	30	34	5,5
GMTC90ES1206	M20x1,5	12	3/8	10	24	35	35	7
GMTC90ES1406	M22x1,5	14	3/8	10	27	33	37	7
GMTC90ES1608	M24x1,5	16	1/2	12	30	39	42	9,5
GMTC90ES2010	M30x2	20	5/8	16	36	54	53	12
GMTC90ES2012	M30x2	20	0,75	20	36	57	59	15
GMTC90ES2512	M36x2	25	0,75	20	46	61	99	15
GMTC90ES2516	M36x2	25	1"	25	46	75	71	20
GMTC90ES3016	M42x2	30	1"	25	50	79	71	20
GMTC90ES3820	M52x2	38	1"1/4	32	60	90	86	26

* CRIMPED NUT

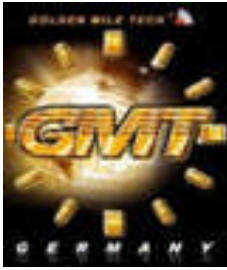

GMTFEL

METRIC O-RING FEMALE, 24° CONE, DIN 3865 LIGHT

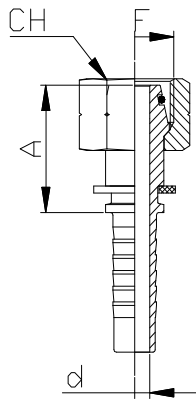

DKOL

Code article	Thread	Standpi pe	øins. Hose		Dimensions (mm)		
			Inch	mm	CH	A	d
GMTFEL0603	M12x1,5	6	3/16	5	14	26	3
GMTFEL0604*	M12x1,5	6	1/4	6	14	26	4
GMTFEL0804	M14x1,5	8	1/4	6	17	26	4
GMTFEL1004	M16x1,5	10	1/4	6	19	28	4
GMTFEL1005	M16x1,5	10	5/16	8	19	28	5,5
GMTFEL1006*	M16x1,5	10	3/8	10	19	24	7
GMTFEL1204	M18x1,5	12	1/4	6	22	28	4
GMTFEL1205	M18x1,5	12	5/16	8	22	28	5,5
GMTFEL1206	M18x1,5	12	3/8	10	22	28	7
GMTFEL1506	M22x1,5	15	3/8	10	27	27	7
GMTFEL1508	M22x1,5	15	1/2	12	27	28	9,5
GMTFEL1808	M26x1,5	18	0,5	16	32	28	9,5
GMTFEL1810	M26x1,5	18	5/8	16	32	29	12
GMTFEL2212	M30x2	22	0,75	20	36	31	15
GMTFEL2816	M36x2	28	1"	25	41	33	20
GMTFEL3520	M45x2	35	1"1/4	32	50	38	26
GMTFEL4224	M52x2	42	1"1/2	40	60	40	32

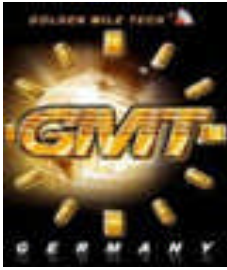

GMTFES

METRIC O-RING FEMALE, 24° CONE, DIN 3865 HEAVY

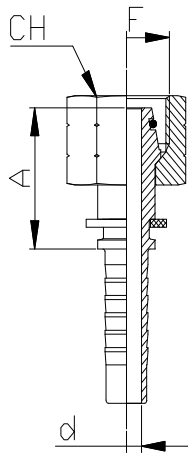

DKOS

Code article	Thread	Standpipe		Dimensions (mm)			
		mm	Inch	mm	CH	A	d
	F						
GMTFES0603	M14x1,5	6	3/16	5	17	26	3
GMTFES0604*	M14x1,5	6	1/4	6	17	26	4
GMTFES0804	M16x1,5	8	1/4	6	19	26	4
GMTFES1004	M18x1,5	10	1/4	6	22	28	4
GMTFES1005	M18x1,5	10	5/16	8	22	28	5,5
GMTFES1006*	M18x1,5	10	3/8	10	22	24	7
GMTFES1204	M20x1,5	12	1/4	6	24	28	4
GMTFES1205	M20x1,5	12	5/16	8	24	28	5,5
GMTFES1206	M20x1,5	12	3/8	10	24	28	7
GMTFES1406	M22x1,5	14	3/8	10	27	31	7
GMTFES1608	M24x1,5	16	1/2	12	30	31	9,5
GMTFES2010	M30x2	20	5/8	16	36	36	12
GMTFES2012	M30x2	20	0,75	20	36	36	15
GMTFES2512	M36x2	25	0,75	20	46	39	15
GMTFES2516	M36x2	25	1"	25	46	40	20
GMTFES3016	M42x2	30	1"	25	50	42	20
GMTFES3820	M52x2	38	1"1/4	32	60	46	26

* CRIMPED NUT



GMTC45EL METRIC SWEPT 45° O-RING FEMALE, 24° CONE, DIN 3865 LIGHT

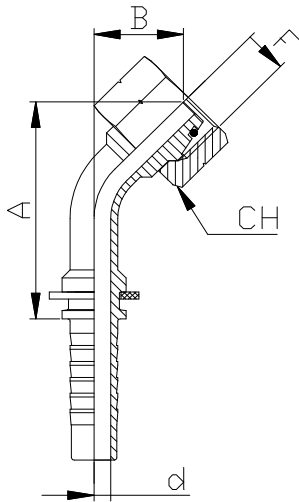

DKOL45

Code article	Thread	Standpi pe mm	øins. Hose		Dimensions (mm)			
			Inch	mm	CH	A	B	d
GMTC45EL0603	M12x1,5	6	3/16	5	14	36	15	3
GMTC45EL0604*	M12x1,5	6	1/4	6	14	38	16	4
GMTC45EL0804	M14x1,5	8	1/4	6	17	38	16	4
GMTC45EL1004	M16x1,5	10	1/4	6	19	38	17	4
GMTC45EL1005	M16x1,5	10	5/16	8	19	44	17	5,5
GMTC45EL1006*	M16x1,5	10	3/8	10	19	60	21	7
GMTC45EL1204	M18x1,5	12	1/4	6	22	40	18	4
GMTC45EL1205	M18x1,5	12	5/16	8	22	46	19	5,5
GMTC45EL1206	M18x1,5	12	3/8	10	22	47	18	7
GMTC45EL1506	M22x1,5	15	3/8	10	27	49	20	7
GMTC45EL1508	M22x1,5	15	1/2	12	27	56	20	9,5
GMTC45EL1808	M26x1,5	18	0,5	12	32	57	24	9,5
GMTC45EL1810	M26x1,5	18	5/8	16	32	57	21	12
GMTC45EL2212	M30x2	22	0,75	20	36	69	26	15
GMTC45EL2816	M36x2	28	1"	25	41	81	32	20
GMTC45EL3520	M45x2	35	1"1/4	32	50	99	40	26
GMTC45EL4224	M52x2	42	1"1/2	40	60	115	43	32

* CRIMPED NUT

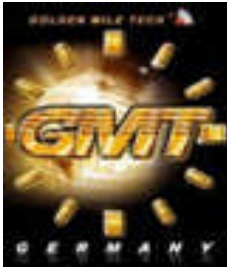

GMTMES

METRIC MALE, 24° SEAT, DIN 3853 HEAVY

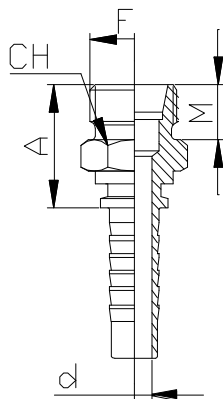

CES

Code article	Thread	Stand pipe	øins. Hose		Dimensions (mm)			
			Inch	mm	CH	A	M	d
	F	mm						
GMTMES0603	M14x1,5	6	3/16	5				
GMTMES0604	M14x1,5	6	1/4	6				
GMTMES0804	M16x1,5	8	1/4	6	17	27	12	4
GMTMES1004	M18x1,5	10	1/4	6	19	27	12	4
GMTMES1005	M18x1,5	10	5/16	8	19	27,2	12	5,5
GMTMES1006	M18x1,5	10	3/8	10	19	27,3	12	7
GMTMES1204	M20x1,5	12	1/4	6	22	29	12	4
GMTMES1205	M20x1,5	12	5/16	8	22	29,2	12	5,5
GMTMES1206	M20x1,5	12	3/8	10	22	29,3	12	7
GMTMES1406	M22x1,5	14	3/8	10	24	31,3	14	7
GMTMES1408	M22x1,5	14	0,5	12	24	31,8	14	9,5
GMTMES1608	M24x1,5	16	1/2	12	27	31,8	14	9,5
GMTMES2010	M30x2	20	5/8	16	32	35,8	16	12
GMTMES2012	M30x2	20	0,75	20	32	36,5	16	15
GMTMES2512	M36x2	25	0,75	20	38	39,5	18	15
GMTMES2516	M36x2	25	1"	25	38	40,8	18	20
GMTMES3016	M42x2	30	1"	25	46	43,8	20	20
GMTMES3820	M52x2	38	1"1/4	32	55	47,4	22	26



GMTGPG

DOUBLE CONNECTOR

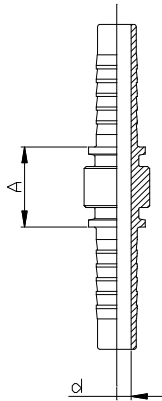

Code article	øins. Hose		Dimensions (mm)	
	Inch	mm	A	d
GMTGPG0303	3/16	5	17	3
GMTGPG0404	1/4	6	17	4
GMTGPG0505	5/16	8	17	6
GMTGPG0606	3/8	10	17	7
GMTGPG0808	1/2	12	18	10
GMTGPG1010	5/8	16	18	12
GMTGPG1212	3/4	20	19	15
GMTGPG1616	1"	25	21	20
GMTGPG2020	1"1/4	32	24	26

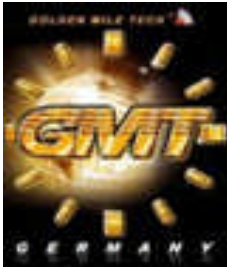

GMTB1A

SKIVE FERRULE FOR SAE 100 R1A - DIN EN 853 1ST

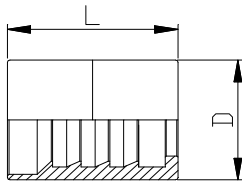

Code article	øins. Hose		Length skive mm	Dimensions (mm)		Hose Type
	Inch	mm		D	L	
GMTB1A03	3/16	5	16	18	26,6	R1A/1ST
GMTB1A04	1/4	6	18,5	20	29,4	R1A/1ST
GMTB1A05	5/16	8	18,5	22	29,5	R1A/1ST
GMTB1A06	3/8	10	20	24	32	R1A/1ST
GMTB1A08	1/2	12	22	29	34	R1A/1ST
GMTB1A10	5/8	16	25	32	36,7	R1A/1ST
GMTB1A12	3/4	20	30	36	42,6	R1A/1ST
GMTB1A16	1"	25	36	43	50,2	R1A/1ST
GMTB1A20	1"1/4	32	41	52	57,2	R1A/1ST
GMTB1A24	1"1/2	40	43	57	63,1	R1A/1ST
GMTB1A32	2"	50	60	70	78,1	R1A/1ST

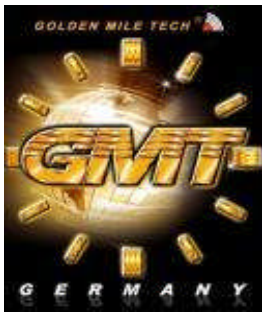

GMTB1T

NO SKIVE FERRULE FOR SAE 100 R1T - DIN EN 853 1SN

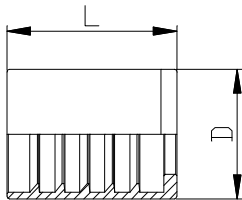

Code article	øins. Hose		Length skive mm	Dimensions (mm)		Hose Type
	Inch	mm		D	L	
GMTB1T03	3/16	5	NO	19	26	R1AT-1SN
GMTB1T04	1/4	6	NO	20	30,5	R1AT-1SN
GMTB1T05	5/16	8	NO	22	30,6	R1AT-1SN
GMTB1T06	3/8	10	NO	24	31,5	R1AT-1SN
GMTB1T08	1/2	12				
GMTB1T10	5/8	16				
GMTB1T12	3/4	20				
GMTB1T16	1"	25	NO	43	50,2	R1AT-1SN
GMTB1T20	1"1/4	32	NO	53	59	R1AT-1SN
GMTB1T24	1"1/2	40	NO	60	73	R1AT-1SN
GMTB1T32	2"	50	NO	78	78,5	R1AT-1SN

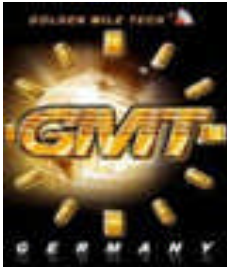

GMTB4H

SKIVE FERRULE FOR DIN EN 856 4SH

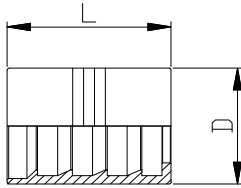

Code article	øins. Hose		Length skive mm	Dimensions (mm)		Hose Type
	Inch	mm		D	L	
B4H20	1"1/4	32	51	52	66	4SH
B4H24	1"1/2	40	58	62	76,5	4SH
B4H32	2"	50	60	75	80	4SH

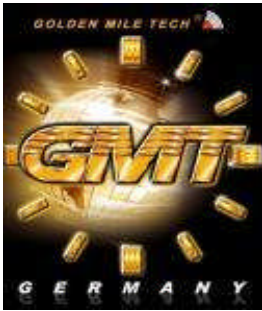

GMTB1C

NO SKIVE FERRULE FOR DIN EN 857 1SC

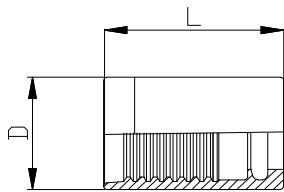

Code article	øins. Hose		Length skive mm	Dimensions (mm)		Hose Type
	Inch	mm		D	L	
GMTB1C04	1/4	6	NO	18	27	1SC
GMTB1C05	5/16	8	NO	20	27	1SC
GMTB1C06	3/8	10	NO	22	30,5	1SC
GMTB1C08	1/2	12	NO	25	32,5	1SC
GMTB1C10	0,625	16	NO	29	36	1SC
GMTB1C12	3/4	20	NO			1SC
GMTB1C16	1"	25	NO			1SC

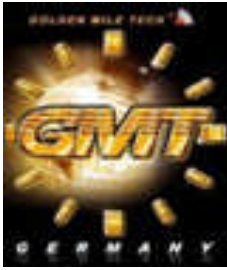

GMTB2T

NO SKIVE FERRULE FOR SAE 100 R2T - DIN EN 853 2SN

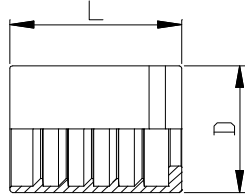

Code article	øins. Hose		Length skive mm	Dimensions (mm)		Hose Type
	Inch	mm		D	L	
GMTB2T03	3/16	5	NO	20	26,9	R2AT-2SN
GMTB2T04	1/4	6	NO	22	30,5	R2AT-2SN
GMTB2T05	5/16	8	NO	24	30,6	R2AT-2SN
GMTB2T06	3/8	10	NO	25,5	31,5	R2AT-2SN
GMTB2T08	1/2	12				
GMTB2T10	5/8	16				
GMTB2T12	3/4	20				
GMTB2T16	1"	25	NO	46	50,2	R2AT-2SN
GMTB2T20	1"1/4	32	NO	56	60	R2AT-2SN
GMTB2T24	1"1/2	40	NO	64	72	R2AT-2SN
GMTB2T32	2"	50	NO	80	80	R2AT-2SN

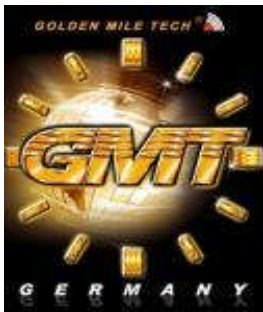

GMTB12

NO SKIVE FERRULE UNIFICATED FOR SAE 100 R1/2T - DIN EN 853 1/2SN

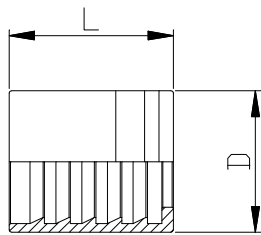

Code article	øins. Hose		Length skive mm	Dimensions (mm)		Hose Type
	Inch	mm		D	L	
GMTB1208	1/2	12	NO	29	34,3	R1/2AT-1/2SN
GMTB1210	5/8	16	NO	32	37	R1/2AT-1/2SN
GMTB1212	3/4	20	NO	36	42,3	R1/2AT-1/2SN

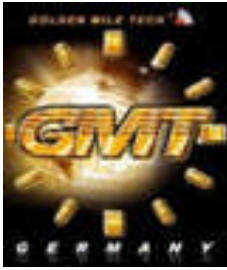

GMTBR7

NO SKIVE FERRULE FOR SAE 100 R7/R8 - DIN EN 855

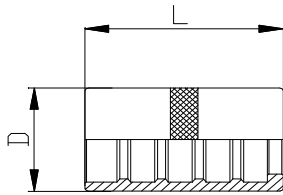

Code article	øins. Hose		Length skive mm	Dimensions (mm)		Hose Type
	Inch	mm		D	L	
GMTBR703	3/16	5	NO	14	30	R7-R8
GMTBR704	1/4	6	NO	17	29	R7-R8
GMTBR705	5/16	8	NO	19	30	R7-R8
GMTBR706	3/8	10	NO	22	31	R7-R8
GMTBR708	1/2	12	NO	25,5	34	R7-R8
GMTBR710	5/8	16	NO	29	37	R7-R8
GMTBR712	3/4	20	NO	33	40,9	R7-R8
GMTBR716	1"	25	NO	40	47,6	R7-R8

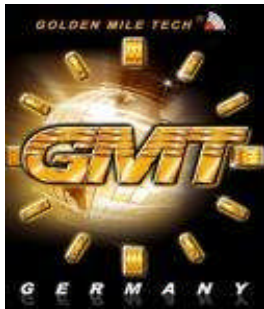

GMTB2A

SKIVE FERRULE FOR SAE 100 R2A - DIN EN 853 2ST

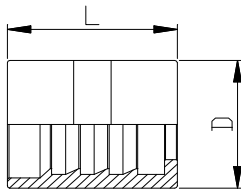

Code article	øins. Hose		Length skive mm	Dimensions (mm)		Hose Type
	Inch	mm		D	L	
GMTB2A03	3/16	5	16,5	20	27,2	R2A-2ST
GMTB2A04	1/4	6	18,5	21	30,1	R2A-2ST
GMTB2A05	5/16	8	18,5	24	30,1	R2A-2ST
GMTB2A06	3/8	10	20	26	31,8	R2A-2ST
GMTB2A08	1/2	12	22	30	33,9	R2A-2ST
GMTB2A10	5/8	16	25	34	37,1	R2A-2ST
GMTB2A12	3/4	20	30	38	42,6	R2A-2ST
GMTB2A16	1"	25	36	46	50,2	R2A-2ST
GMTB2A20	1"1/4	32	41	56	59,3	R2A-2ST
GMTB2A24	1"1/2	40	43	62	63	R2A-2ST
GMTB2A32	2"	50	60	75	79	R2A-2ST



GMTBUN

NO SKIVE FERRULE UNIFICATED FOR SAE 100 R1/2T - DIN EN 853 1/2SN

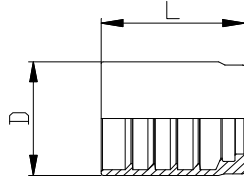

Code article	øins. Hose		Length skive mm	Dimensions (mm)		Hose Type
	Inch	mm		D	L	
GMTBUN04	1/4	6	NO	23	26	R1/2AT-1/2SN
GMTBUN05	5/16	8	NO	24	26,2	R1/2AT-1/2SN
GMTBUN06	3/8	10	NO	26	30,5	R1/2AT-1/2SN
GMTBUN08	1/2	12	NO	29	32,5	R1/2AT-1/2SN
GMTBUN10	5/8	16	NO	33	36	R1/2AT-1/2SN
GMTBUN12	3/4	20	NO	37	39	R1/2AT-1/2SN
GMTBUN16	1"	25	NO	46	44	R1/2AT-1/2SN
GMTBUN20	1"1/4	32	NO	59	59	R1/2AT-1/2SN
GMTBUN24	1"1/2	40	NO	67	67	R1/2AT-1/2SN
GMTBUN32	2"	50	NO	80	72	R1/2AT-1/2SN

COMPATIBLE ALSO WITH 2SC-R2K

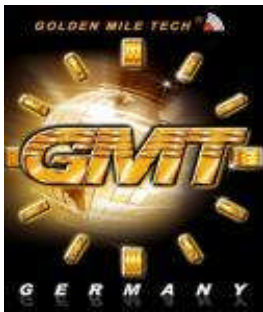

GMTB4P

SKIVE FERRULE FOR SAE 100 R9R/R10/R12 - DIN EN 856 4SP

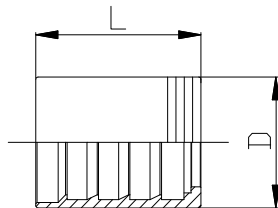

Code article	øins. Hose		Length skive mm	Dimensions (mm)		Hose Type
	Inch	mm		D	L	
GMTB4P04	1/4	6	19	22	30	R9R-4SP
GMTB4P06	3/8	10	23	26	31,8	R9R-4SP
GMTB4P08	1/2	12	23	30	34	R9R-4SP
GMTB4P10	5/8	16	32	34	45	R9R-4SP
GMTB4P12	3/4	20	37	38	51,8	R9R-4SP-4SH
GMTB4P16	1"	25	43	46	60	R9R-4SP-4SH
GMTB4P20	1"1/4	32	49	56	66,2	R10-4SP
GMTB4P24	1"1/2	40	55,5	65	77	R10-4SP
GMTB4P32	2"	50	58,5	80	80	R10-4SP



GMTFLPIR

SUPERCAT FLANGE SWEPT 90°

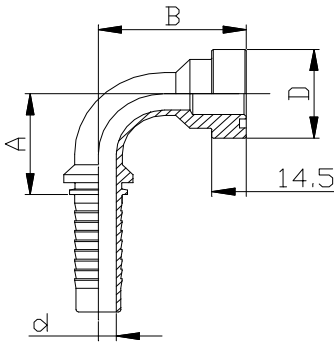

Code article	Flange		øins. Hose		Dimensions (mm)			
			Inch	mm	A	B	D	d
GMTFLPIR69012	3/4	3/4	3/4	19	62	60,0	41,28	15
GMTFLPIR69016	1"	3/4	3/4	19	62	67,0	47,63	15
GMTFLPIR69016	1"	1"	1"	25	74	79,0	47,63	20
GMTFLPIR69020	1"1/4	1"	1"	25	74	85,0	53,98	20
GMTFLPIR69020	1"1/4	1"1/4	1"1/4	32	92	94,0	54	26

Made from Solid

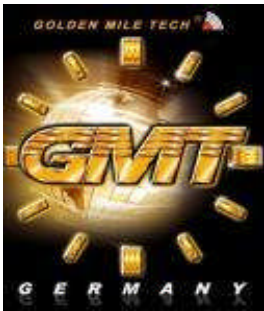

GMTSEM6

SAE SPLIT FLANGE 6000 PSI - SAE J518

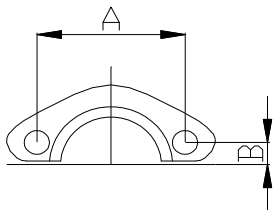

Code article	Flange		D. Flangi a	Dimensions (mm)		
	inch			A		B
GMTSEM608	1/2		31,7	40,49		9,2
GMTSEM612	3/4		41,3	50,8		11,9
GMTSEM616	1"		47,6	57,15		13,89
GMTSEM620	1"1/4		54	66,68		15,7
GMTSEM624	1"1/2		63,5	79,38		18,2
GMTSEM632	2"		79,4	96,82		22,23

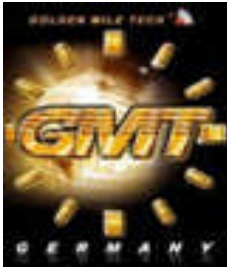

GMTSEM3

SAE SPLIT FLANGE 3000 PSI - SAE J518

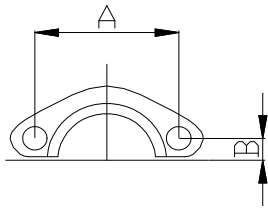

Code article	Flange		D. Flangi a	Dimensions (mm)		
	inch			mm	A	B
GMTSEM308	1/2		30,2	38,1		8,8
GMTSEM312	3/4		38,1	47,63		11,13
GMTSEM316	1"		44,5	52,37		13,08
GMTSEM320	1"1/4		50,8	58,72		15,09
GMTSEM324	1"1/2		60,4	69,85		17,86
GMTSEM332	2"		71,4	77,77		21,5

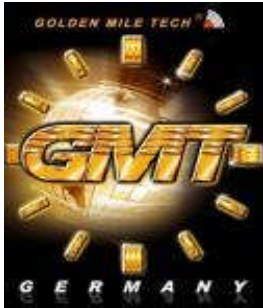

GMTFLPIR

SUPERCAT FLANGE SWEPT 45°

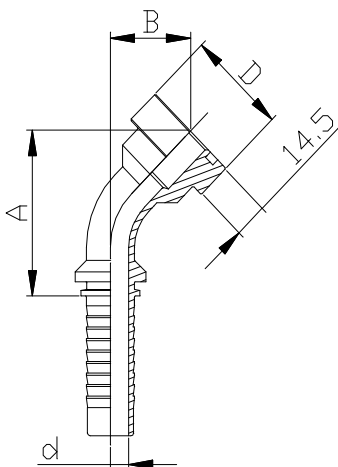

Code article	Flange	øins. Hose		Dimensions (mm)			
		Inch	mm	A	B	D	d
GMTFLPIR64512	3/4	3/4	19	76	30	41,28	15
GMTFLPIR64516	1"	3/4	19	82	35	47,6	15
GMTFLPIR64516	1"	1"	25	95	42	47,6	20
GMTFLPIR64520	1"1/4	1"	25	100	46	53,98	20
GMTFLPIR64520	1"1/4	1"1/4	32	106	52,0	54	26

Made from Solid



GMTFLPI6

SAE FLANGE 6000 PSI SWEPT 90° - SAE J518

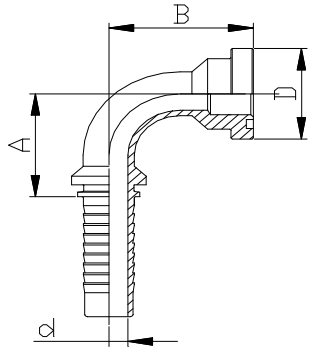

Code article	Flange	øins. Hose		Dimensions (mm)			
		Inch	mm	A	B	D	d
GMTFLPI6900808	1/2	1/2	12	39	39	31,7	9,5
GMTFLPI6901208	3/4	1/2	12	39	43	41,3	9,5
GMTFLPI6901210	3/4	5/8	16	56	57	41,3	12
GMTFLPI6901212	3/4	3/4	20	56	57	41,3	15
GMTFLPI6901612	1"	3/4	20	56	63	47,6	15
GMTFLPI6901616	1"	1"	25	70	70	47,6	20
GMTFLPI6902016	1"1/4	1"	25	70	77	54,0	20
GMTFLPI6902020	1"1/4	1"1/4	32	85	88	54,0	26
GMTFLPI6902420	1"1/2	1"1/4	32	85	96	64	26
GMTFLPI6902424	1"1/2	1"1/2	40	99	103	63,5	32
GMTFLPI6903224	2"	1"1/2	40	99	116	79,4	32
GMTFLPI6903232	2"	2"	50	125	136	79,4	42

Made from Solid

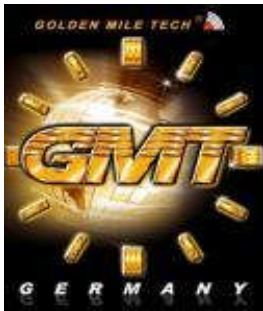

GMTFLPI3

SAE FLANGE 3000 PSI SWEPT 45° - SAE J518

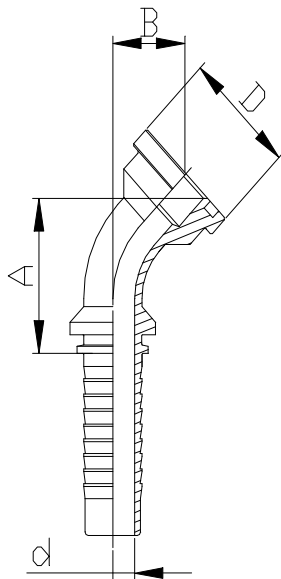

Code article	Flange	øins. Hose		Dimensions (mm)			
		Inch	mm	A	B	D	d
GMTFLPI3450808	1/2	1/2	12	51	22	30,2	9,5
GMTFLPI3451208	3/4	1/2	12	54	25	38,1	9,5
GMTFLPI3451210	3/4	5/8	16	69	27	38,1	12
GMTFLPI3451212	3/4	3/4	20	69	27	38,1	15
GMTFLPI3451612	1"	3/4	20	73	31	44,5	15
GMTFLPI3451616	1"	1"	25	82	33	44,5	20
GMTFLPI3452016	1"1/4	1"	25	86	37	50,8	20
GMTFLPI3452020	1"1/4	1"1/4	32	100	47	50,8	26
GMTFLPI3452420	1"1/2	1"1/4	32	102	49	60	26
GMTFLPI3452424	1"1/2	1"1/2	40	111	50	60,4	32
GMTFLPI3453224	2"	1"1/2	40	113	52	71,4	32
GMTFLPI3453232	2"	2"	50	129	56	71,4	44

Made from Solid

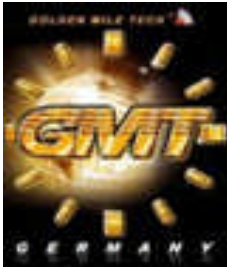

GMTFLPI3

SAE FLANGE 3000 PSI SWEPT 90° - SAE J518

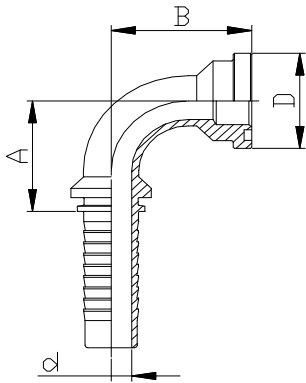

Code article	Flange	øins. Hose		Dimensions (mm)			
		Inch	mm	A	B	D	d
GMTFLPI3900808	1/2	1/2	12	39	39	30,2	9,5
GMTFLPI3901208	3/4	1/2	12	39	44	38,1	9,5
GMTFLPI3901210	3/4	5/8	16	56	53	38,1	12
GMTFLPI3901212	3/4	3/4	20	56	53	38,1	15
GMTFLPI3901612	1"	3/4	20	56	58	44,5	15
GMTFLPI3901616	1"	1"	25	70	65	44,5	20
GMTFLPI3902016	1"1/4	1"	25	70	70	50,8	20
GMTFLPI3902020	1"1/4	1"1/4	32	85	81	50,8	26
GMTFLPI3902420	1"1/2	1"1/4	32	85	85	60	26
GMTFLPI3902424	1"1/2	1"1/2	40	99	92	60,4	32
GMTFLPI3903224	2"	1"1/2	40	99	95	71,5	32
GMTFLPI3903232	2"	2"	50	125	115	71,5	44

Made from Solid

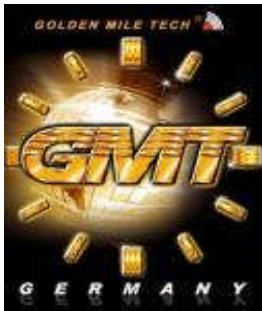

GMTFLPIR

SUPERCAT FLANGE

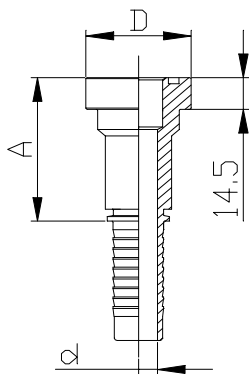

Code article	Flange	øins. Hose		Dimensions (mm)			
		Inch	mm	A	D	d	
GMTFLPIR61212		3/4	3/4	19	59	41,3	15
GMTFLPIR61612		1"	3/4	19	66	47,6	15
GMTFLPIR61616		1"	1"	25	67	47,6	20
GMTFLPIR62016		1"1/4	1"	25	75	54,0	20
GMTFLPIR62020		1"1/4	1"1/4	32	77	54,0	26

Made from Solid



GMTFLPI645

SAE FLANGE 6000 PSI SWEPT 45° - SAE J518

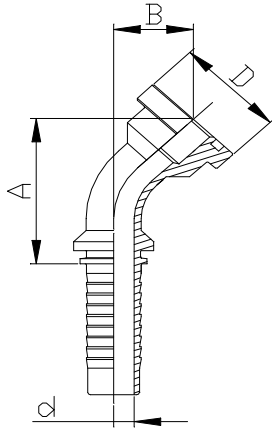

Code article	Flange	øins. Hose		Dimensions (mm)			
		Inch	mm	A	B	D	d
GMTFLPI6450808	1/2	1/2	12	51	22	31,7	9,5
GMTFLPI6451208	3/4	1/2	12	57	28	41,3	9,5
GMTFLPI6451210	3/4	5/8	16	72	30	41,3	12
GMTFLPI6451212	3/4	3/4	20	72	30	41,3	15
GMTFLPI6451612	1"	3/4	20	76	34	47,6	15
GMTFLPI6451616	1"	1"	25	85	36	47,6	20
GMTFLPI6452016	1 1/4	1"	25	90	41	54,0	20
GMTFLPI6452020	1 1/4	1 1/4	32	104	51	54,0	26
GMTFLPI6452420	1 1/2	1 1/4	32	109	56	64	26
GMTFLPI6452424	1 1/2	1 1/2	40	118	57	63,5	32
GMTFLPI6453224	2"	1 1/2	40	127	66	79,4	32
GMTFLPI6453232	2"	2"	50	145	71	79,4	44

Made from Solid

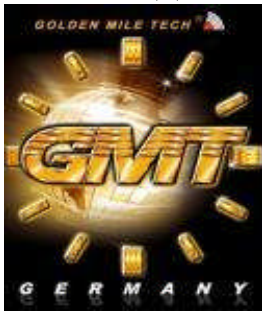

GMTFLPI3

SAE FLANGE 3000 PSI - SAE J518

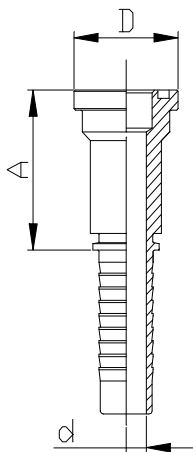

Code article	Flange	øins. Hose		Dimensions (mm)		
		Inch	mm	A	D	d
GMTFLPI30808	1/2	1/2	12	45	30,2	9,5
GMTFLPI31208	3/4	1/2	12	50	38,1	9,5
GMTFLPI31210	3/4	5/8	16	50	38,1	12,0
GMTFLPI31212	3/4	3/4	20	50	38,1	15,0
GMTFLPI31612	1"	3/4	20	53	44,5	15,0
GMTFLPI31616	1"	1"	25	54	44,5	20,0
GMTFLPI32016	1 1/4	1"	25	57	50,8	20,0
GMTFLPI32020	1 1/4	1 1/4	32	59	50,8	26,0
GMTFLPI32420	1 1/2	1 1/4	32	62	60,4	26
GMTFLPI32424	1 1/2	1 1/2	40	62	60,4	32,0
GMTFLPI33224	2"	1 1/2	40	67	71,4	32,0
GMTFLPI33232	2"	2"	50	68	71,4	44,0

Made from Solid

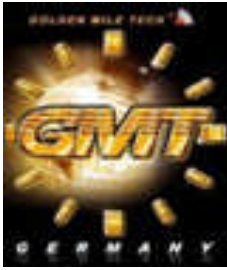

GMTFLPI6

SAE FLANGE 6000 PSI - SAE J518

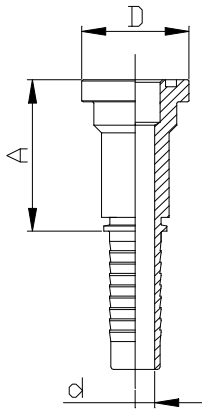

Code article	Flange	øins. Hose		Dimensions (mm)		
		Inch	mm	A	D	d
GMTFLPI60808	1/2	1/2	12	46	31,7	9,5
GMTFLPI61208	3/4	1/2	12	53	41,3	9,5
GMTFLPI61210	3/4	5/8	16	54	41,3	12,0
GMTFLPI61212	3/4	3/4	20	54	41,3	15,0
GMTFLPI61612	1"	3/4	20	60	47,6	15,0
GMTFLPI61616	1"	1"	25	61	47,6	20,0
GMTFLPI62016	1"1/4	1"	25	68	54	20,0
GMTFLPI62020	1"1/4	1"1/4	32	70	54	26,0
GMTFLPI62420	1"1/2	1"1/4	32	76	63,5	26
GMTFLPI62424	1"1/2	1"1/2	40	76	63,5	32,0
GMTFLPI63224	2"	1"1/2	40	85	79,4	32,0
GMTFLPI63232	2"	2"	50	85	79,4	44,0

Made from Solid

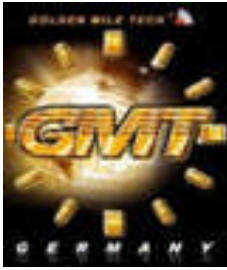

GMTFM

METRIC FEMALE, 60° CONE

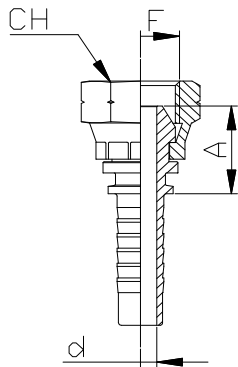

Code article	Thread	øins. Hose		Dimensions (mm)		
		Inch	mm	CH	A	d
	F					
GMTFM1003	10x1	3/16	5	15	16,8	3
GMTFM1004	10x1	1/4	6	15	17	4
GMTFM1203	12x1,5	3/16	5	17	18,2	3
GMTFM1204	12x1,5	1/4	6	17	18,5	4
GMTFM1205	12x1,5	5/16	8			
GMTFM1404	14x1,5	1/4	6	19	18,9	4
GMTFM1405	14x1,5	5/16	8	19	18,9	5,5
GMTFM1406	14x1,5	3/8	10	19	19	7
GMTFM1604	16x1,5	1/4	6	22	20,1	4
GMTFM1605	16x1,5	5/16	8	22	20,1	5,5
GMTFM1606	16x1,5	3/8	10	22	20,2	7
GMTFM1804	18x1,5	1/4	6	24	20,1	4
GMTFM1805	18x1,5	5/16	8	24	20,1	5,5
GMTFM1806	18x1,5	3/8	10	24	20,2	7
GMTFM1808	18x1,5	1/2	12	24	20,7	9,5
GMTFM2006	20x1,5	3/8	10	27	22,4	7
GMTFM2008	20x1,5	1/2	12	27	22,9	9,5
GMTFM2206	22x1,5	3/8	10	27	22,4	7
GMTFM2208	22x1,5	1/2	12	27	22,9	9,5
GMTFM2210	22x1,5	5/8	16	27	22,9	12
GMTFM2610	26x1,5	5/8	16	32	25,4	12
GMTFM2612	26x1,5	3/4	20	32	25,6	15
GMTFM3012	30x1,5	3/4	20	36	26,3	15
GMTFM3016	30x1,5	1"	25			

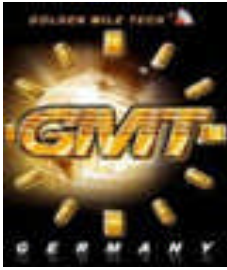

GMTOM

METRIC BANJO

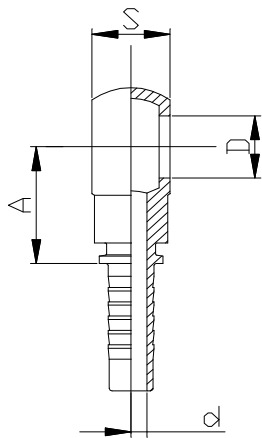

Code article	Banjo Bolt	øins. Hose		Dimensions (mm)		
		Inch	mm	A	S	d
GMTOM1003	M 10	3/16	5	19,3	10	3
GMTOM1004	M 10	1/4	6	24,2	10	4
GMTOM1203	M 12	3/16	5	22,3	12	3
GMTOM1204	M 12	1/4	6	22,5	12	4
GMTOM1205	M 12	5/16	8			
GMTOM1404	M 14	1/4	6	24,8	14	4
GMTOM1405	M 14	5/16	8	24,5	14	5,5
GMTOM1406	M 14	3/8	10	32,2	14	7
GMTOM1604	M 16	1/4	6	27,2	17	4
GMTOM1605	M 16	5/16	8	26,8	17	5,5
GMTOM1606	M 16	3/8	10	26,8	17	7
GMTOM1804	M 18	1/4	6	28,5	20	4
GMTOM1805	M 18	5/16	8	29,2	20	5,5
GMTOM1806	M 18	3/8	10	28,2	20	7
GMTOM1808	M 18	1/2	12	29,2	20	9,5
GMTOM2006	M 20	3/8	10	29,5	22	7
GMTOM2008	M 20	1/2	12	32,4	22	9,5
GMTOM2206	M 22	3/8	10	27,7	22	7
GMTOM2208	M 22	1/2	12	33,8	22	9,5
GMTOM2210	M 22	5/8	16	30,8	22	12
GMTOM2410	M 24	5/8	16	30,8	26	12
GMTOM2610	M 26	0,625	16	39,3	30	12
GMTOM2612	M 26	3/4	20	37	30	15
GMTOM3012	M 30	3/4	20			
GMTOM3016	M 30	1"	25	44,8	30	20



GMTC90M METRIC SWEPT 90° FEMALE, 60° CONE

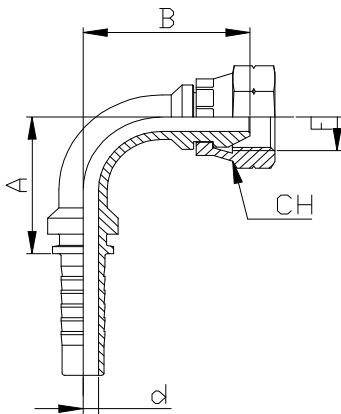

Code article	Thread	øins. Hose		Dimensions (mm)			
		Inch	mm	CH	A	B	d
GMTC90M1003	10x1	3/16	5	15	23	26	3
GMTC90M1004	10x1	1/4	6	15	22	28	4
GMTC90M1203	12x1,5	3/16	5	17	23	26	3
GMTC90M1204	12x1,5	1/4	6	17	22	28	4
GMTC90M1205	12x1,5	5/16	8				
GMTC90M1404	14x1,5	1/4	6	19	21	30	4
GMTC90M1405	14x1,5	5/16	8	19	28,5	34	5,5
GMTC90M1406	14x1,5	3/8	10	19	28,5	34	7
GMTC90M1604	16x1,5	1/4	6	22	26	32	4
GMTC90M1605	16x1,5	5/16	8	22	32	38	5,5
GMTC90M1606	16x1,5	3/8	10	22	34	38	7
GMTC90M1804	18x1,5	1/4	6	24	26	32	4
GMTC90M1805	18x1,5	5/16	8	24	32	38	5,5
GMTC90M1806	18x1,5	3/8	10	24	34	38	7
GMTC90M1808	18x1,5	1/2	12	24	42	39	9,5
GMTC90M2006	20x1,5	3/8	10	27	33	42	7
GMTC90M2008	20x1,5	1/2	12	27	40	44	9,5
GMTC90M2206	22x1,5	3/8	10	27	33	42	7
GMTC90M2208	22x1,5	1/2	12	27	40	44	9,5
GMTC90M2210	22x1,5	5/8	16	27	43	47	12
GMTC90M2610	26x1,5	5/8	16	32	45	54	12
GMTC90M2612	26x1,5	3/4	20	32	54	59	15
GMTC90M3012	30x1,5	3/4	20	36	54	63	15
GMTC90M3016	30x1,5	1"	25				

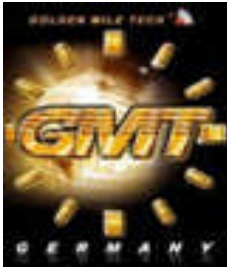

GMTMM METRIC MALE, 60° SEAT

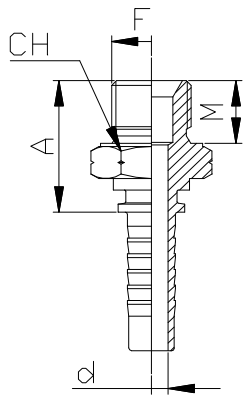

Code article	Thread	øins. Hose		Dimensions (mm)			
		Inch	mm	CH	A	M	d
	F						
GMTMM1003	10x1	3/16	5	15	19,4	8	3
GMTMM1004	10x1	1/4	6	15	19,7	8	4
GMTMM1203	12x1,5	3/16	5	17	24,8	11	3
GMTMM1204	12x1,5	1/4	6	17	25,1	11	4
GMTMM1205	12x1,5	5/16	8				
GMTMM1404	14x1,5	1/4	6	19	26,2	12	4
GMTMM1405	14x1,5	5/16	8	19	26,4	12	5,5
GMTMM1406	14x1,5	3/8	10	19	26,5	12	7
GMTMM1604	16x1,5	1/4	6	22	28,4	13	4
GMTMM1605	16x1,5	5/16	8	22	28,6	13	5,5
GMTMM1606	16x1,5	3/8	10	22	28,7	13	7
GMTMM1804	18x1,5	1/4	6	24	29,4	14	4
GMTMM1805	18x1,5	5/16	8	24	29,6	14	5,5
GMTMM1806	18x1,5	3/8	10	24	29,7	14	7
GMTMM1808	18x1,5	1/2	12	24	30,2	14	9,5
GMTMM2006	20x1,5	3/8	10	27	30,9	14	7
GMTMM2008	20x1,5	1/2	12	27	31,4	14	9,5
GMTMM2206	22x1,5	3/8	10	27	31,9	15	7
GMTMM2208	22x1,5	1/2	12	27	32,4	15	9,5
GMTMM2210	22x1,5	5/8	16	27	32,4	15	12
GMTMM2610	26x1,5	5/8	16	32	34,6	16	12
GMTMM2612	26x1,5	3/4	20	32	35,3	16	15
GMTMM3012	30x1,5	3/4	20	36	36,5	16	15
GMTMM3016	30x1,5	1"	25				



GMTC45 METRIC SWEPT 45° FEMALE, 60° CONE

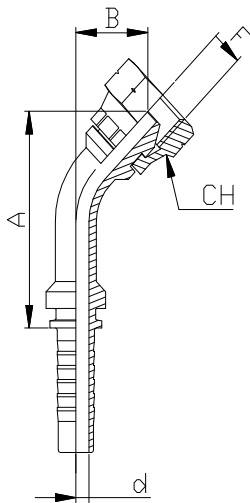

Code article	Thread	øins. Hose		Dimensions (mm)			
		Inch	mm	CH	A	B	d
GMTC45M1003	10x1	3/16	5	15	38	16	3
GMTC45M1004	10x1	1/4	6	15	42	20	4
GMTC45M1203	12x1,5	3/16	5	17	40	16	3
GMTC45M1204	12x1,5	1/4	6	17	41	20	4
GMTC45M1205	12x1,5	5/16	8				
GMTC45M1404	14x1,5	1/4	6	19	40	16	4
GMTC45M1405	14x1,5	5/16	8	19	40	20	5
GMTC45M1406	14x1,5	3/8	10	19	42	20	7
GMTC45M1604	16x1,5	1/4	6	22	40	18	4
GMTC45M1605	16x1,5	5/16	8	22	51	19	5,5
GMTC45M1606	16x1,5	3/8	10	22	56	19	7
GMTC45M1804	18x1,5	1/4	6	22	40	18	4
GMTC45M1805	18x1,5	5/16	8	22	51	19	5,5
GMTC45M1806	18x1,5	3/8	10	22	56	19	7
GMTC45M1808	18x1,5	1/2	12	22	62	23	9,5
GMTC45M2006	20x1,5	3/8	10	27	50	19,5	7
GMTC45M2008	20x1,5	1/2	12	27	65	25	9,5
GMTC45M2206	22x1,5	3/8	10	27	50	19,5	7
GMTC45M2208	22x1,5	1/2	12	27	65	25	9,5
GMTC45M2210	22x1,5	5/8	16	27	55	31	12
GMTC45M2610	26x1,5	5/8	16	32	68	29	12
GMTC45M2612	26x1,5	3/4	20	32	64	30	15
GMTC45M3012	30x1,5	3/4	20	36	64	35	15
GMTC45M3016	30x1,5	1"	25				



GMTMNPT NPTF MALE

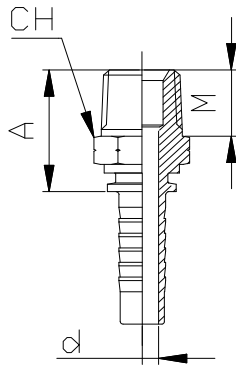

Code article	Thread	øins. Hose		Dimensions (mm)			
		Inch	mm	CH	A	M	d
	F						
GMTMNPT0203	1/8 - 27	3/16	5	12	21,6	9,7	3
GMTMNPT0204	1/8 - 27	1/4	6	12	21,9	9,7	4
GMTMNPT0403	1/4 - 18	3/16	5	15	26,9	14,2	3
GMTMNPT0404	1/4 - 18	1/4	6	15	27,2	14,2	4
GMTMNPT0405	1/4 - 18	5/16	8	15	27,2	14,2	5,5
GMTMNPT0406	1/4 - 18	3/8	10	15	27,3	14,2	7
GMTMNPT0604	3/8 - 18	1/4	6	19	28,2	14,2	4
GMTMNPT0605	3/8 - 18	5/16	8	19	28,4	14,2	5,5
GMTMNPT0606	3/8 - 18	3/8	10	19	28,5	14,2	7
GMTMNPT0608	3/8 - 18	1/2	12	19	29	14,2	9,5
GMTMNPT0805	1/2 - 14	5/16	8				
GMTMNPT0806	1/2 - 14	3/8	10	22	34,3	19	7
GMTMNPT0808	1/2 - 14	1/2	12	22	34,8	19	9,5
GMTMNPT0810	1/2 - 14	5/8	16				
GMTMNPT1208	3/4 - 14	1/2	12	27	35,8	19	9,5
GMTMNPT1210	3/4 - 14	5/8	16	27	35,8	19	12
GMTMNPT1212	3/4 - 14	3/4	20	27	36,5	19	15
GMTMNPT1610	1" - 11,5	5/8	16				
GMTMNPT1612	1" - 11,5	3/4	20	36	42,4	23,9	15
GMTMNPT1616	1" - 11,5	1"	25	36	43,7	23,9	20
GMTMNPT2016	1"1/4 - 11,5	1"	25	46	47,9	24,6	20
GMTMNPT2020	1"1/4 - 11,5	1"1/4	32	46	48,5	24,6	26
GMTMNPT2420	1"1/2 - 11,5	1"1/4	32	50	49,6	25,4	26
GMTMNPT2424	1"1/2 - 11,5	1"1/2	40	50	50,5	25,4	32
GMTMNPT3224	2" - 11,5	1"1/2	40				
GMTMNPT3232	2" - 11,5	2"	50	65	52,5	26,2	44

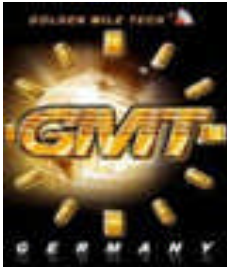

GMTCOD90

METRIC SWEPT 90° STANDPIPE, DIN 2353

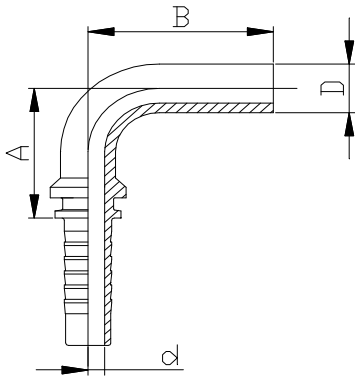

Code article	Stand pipe D (mm)	øins. Hose		Dimensions (mm)		
		Inch	mm	A	B	d
GMTCOD900603	6	3/16	5	27,5	37,6	3
GMTCOD900604	6	1/4	6	27,5	37,6	4
GMTCOD900803	8	3/16	5	27,5	37,6	3
GMTCOD900804	8	1/4	6	27,5	37,6	4
GMTCOD900805	8	5/16	8	27,5	37,6	5,5
GMTCOD901004	10	1/4	6	32	35,5	4
GMTCOD901005	10	5/16	8	32	43,6	5,5
GMTCOD901006	10	3/8	10	32	40,8	7
GMTCOD901204	12	1/4	6	33	42,5	4
GMTCOD901205	12	5/16	8	33	44	5,5
GMTCOD901206	12	3/8	10	33	48	7
GMTCOD901208	12	1/2	12	33	45	9,5
GMTCOD901406	14	3/8	10	35	48	7
GMTCOD901408	14	1/2	12	35	48	9,5
GMTCOD901506	15	3/8	10	38	53	7
GMTCOD901508	15	1/2	12	38	53	9,5
GMTCOD901608	16	1/2	12	43	55,6	9,5
GMTCOD901808	18	1/2	12	45	58	9,5
GMTCOD901810	18	5/8	16	45	58	12
GMTCOD901812	18	3/4	20	47	58	15
GMTCOD902008	20	1/2	12	49	60	9,5
GMTCOD902010	20	5/8	16	51	62,6	12
GMTCOD902012	20	3/4	20	51	65,3	15
GMTCOD902210	22	5/8	16	48	63,5	12
GMTCOD902212	22	3/4	20	55	71,7	15
GMTCOD902512	25	3/4	20	58	73,5	15
GMTCOD902516	25	1"	25	61	73,5	20
GMTCOD902816	28	1"	25	68	84	20
GMTCOD903016	30	1"	25	76	87	20
GMTCOD903520	35	1"1/4	32	76	93	26
GMTCOD903820	38	1"1/4	32	83	105	26
GMTCOD903824	38	1"1/2	40	89	105	32
GMTCOD904224	42		40	108	124	32



GMTCOD

METRIC STANDPIPE, DIN 2353

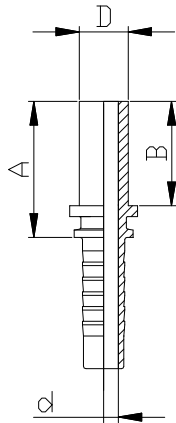

Code article	Stand pipe D (mm)	øins. Hose		Dimensions (mm)		
		Inch	mm	A	B	d
GMTCOD0603	6	3/16	5	30,7	24	3
GMTCOD0604	6	1/4	6	31	24	4
GMTCOD0803	8	3/16	5	30,7	24	3
GMTCOD0804	8	1/4	6	31	24	4
GMTCOD0805	8	5/16	8	31,2	24	5,5
GMTCOD1004	10	1/4	6	31,2	24	4
GMTCOD1005	10	5/16	8	31,2	24	5,5
GMTCOD1006	10	3/8	10	31,3	24	7
GMTCOD1204	12	1/4	6	32	27,3	4
GMTCOD1205	12	5/16	8	32,2	25	5,5
GMTCOD1206	12	3/8	10	32,3	25	7
GMTCOD1208	12	1/2	12	32,8	25	9,5
GMTCOD1406	14	3/8	10	36,3	29	7
GMTCOD1408	14	1/2	12	36,8	29	9,5
GMTCOD1506	15	3/8	10	36,3	29	7
GMTCOD1508	15	1/2	12	36,8	29	9,5
GMTCOD1608	16	1/2	12	36,8	29	9,5
GMTCOD1808	18	1/2	12	36,8	29	9,5
GMTCOD1810	18	5/8	16	36,8	29	12
GMTCOD1812	18	3/4	20	37,5	29	15
GMTCOD2008	20	1/2	12	43,8	38,5	9,5
GMTCOD2010	20	5/8	16	43,8	36	12
GMTCOD2012	20	3/4	20	44,5	36	15
GMTCOD2210	22	5/8	16	36,8	29	12
GMTCOD2212	22	3/4	20	37,5	29	15
GMTCOD2512	25	3/4	20	44,5	36	15
GMTCOD2516	25	1"	25	45,8	36	20
GMTCOD2816	28	1"	25	45,8	36	20
GMTCOD3016	30	1"	25	45,8	36	20
GMTCOD3520	35	1"1/4	32	47	35	26
GMTCOD3820	38	1"1/4	32	59,1	48	26
GMTCOD3824	38	1"1/2	40	60	48	32
GMTCOD4224	42		40	47,4	36	32

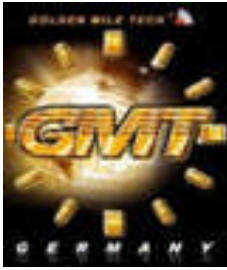

GMTCOD45

METRIC SWEPT 45° STANDPIPE, DIN 2353

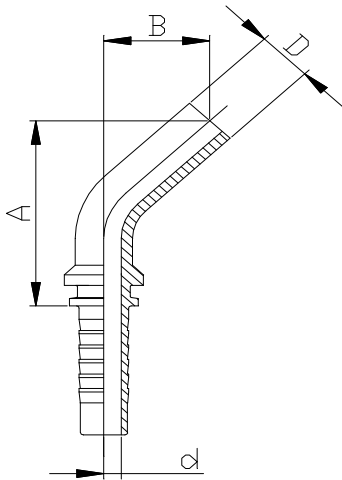

Code article	Standpipe	øins. Hose		Dimensions (mm)		
	D (mm)	Inch	mm	A	B	d
GMTCOD450603	6	3/16	5	40	18	3
GMTCOD450604	6	1/4	6	40	20	4
GMTCOD450803	8	3/16	5	46	20	3
GMTCOD450804	8	1/4	6	46	20	4
GMTCOD450805	8	5/16	8	46	20	5,5
GMTCOD451004	10	1/4	6	43	20	4
GMTCOD451005	10	5/16	8	43	20	5,5
GMTCOD451006	10	3/8	10	43	22	7
GMTCOD451204	12	1/4	6	52	24	4
GMTCOD451205	12	5/16	8	52	24	5,5
GMTCOD451206	12	3/8	10	52	25	7
GMTCOD451208	12	1/2	12	52	25	9,5
GMTCOD451406	14	3/8	10	52	25	7
GMTCOD451408	14	1/2	12	52	31	9,5
GMTCOD451506	15	3/8	10	56	24	7
GMTCOD451508	15	1/2	12	56	24	9,5
GMTCOD451608	16	1/2	12	54	25	9,5
GMTCOD451808	18	1/2	12	61	26	9,5
GMTCOD451810	18	5/8	16	75	33	12
GMTCOD451812	18	3/4	20	62	30	15
GMTCOD452008	20	1/2	12	65	40	9,5
GMTCOD452010	20	5/8	16	81	40	12
GMTCOD452012	20	3/4	20	70	40	15
GMTCOD452210	22	5/8	16	77	34	12
GMTCOD452212	22	3/4	20	77	34	15
GMTCOD452512	25	3/4	20	82	36	15
GMTCOD452516	25	1"	25	82	36	20
GMTCOD452816	28	1"	25	87	44	20
GMTCOD453016	30	1"	25	90	44	20
GMTCOD453520	35	1"1/4	32	99	46	26
GMTCOD453820	38	1"1/4	32	104	51	26
GMTCOD453824	38	1"1/2	40	104	51	32
GMTCOD454224	42		40	113	60	32

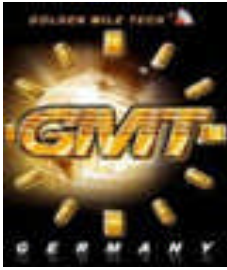

GMTFMK

PRESSURE WASH FEMALE "K"

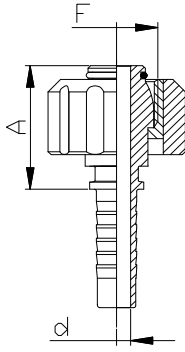

Code article	Thread	øins. Hose		Dimensions (mm)	
		Inch	mm	A	d
GMTFMK2204	22x1,5	1/4	6	30,7	4
GMTFMK2205	22x1,5	5/16	8	30,7	5,5
GMTFMK2206	22x1,5	3/8	10	30,7	7



GMTRS

WELDING INSERT

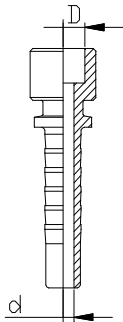

Code article	øins. Hose		Dimensions (mm)	
	Inch	mm	D	d
GMTRS0406	1/4	6	6	4
GMTRS0408	1/4	6	8	4
GMTRS0410	1/4	6	10	4
GMTRS0510	5/16	8	10	5,5
GMTRS0512	5/16	8	12	5,5
GMTRS0610	3/8	10	10	7
GMTRS0612	3/8	10	12	7
GMTRS0614	3/8	10	14	7
GMTRS0814	1/2	12	14	9,5
GMTRS0815	1/2	12	15	9,5
GMTRS0816	1/2	12	16	9,5
GMTRS1018	5/8	16	18	12
GMTRS1220	3/4	20	20	15
GMTRS1222	3/4	20	22	15
GMTRS1626	1"	25	26	20
GMTRS2032	1"1/4	32	32	26
GMTRS2438	1"1/2	40	38	32
GMTRS3250	2"	50	50	44

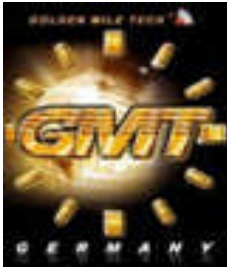

GMTMW

CO² MALE WHITWORTH THREAD

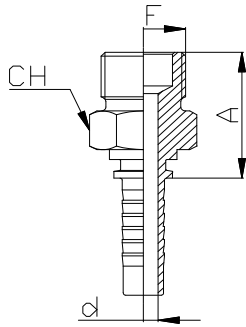

Code article	Thread	øins. Hose		Dimensions (mm)		
		Inch	mm	CH	A	d
GMTMW21706	F	3/8	9,5	24	27	7
GMTMW21708	F	1/2	12,7	24	27	9,5

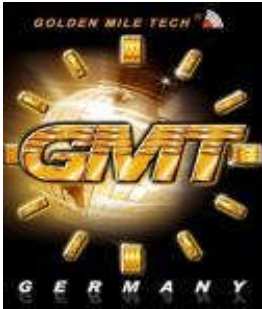

GMTFW

CO² FEMALE WHITWORTH THREAD

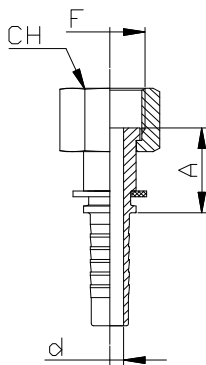

Code article	Thread	øins. Hose		Dimensions (mm)		
		Inch	mm	CH	A	d
GMTFW21706	F	3/8	9,5	27	18,6	7
GMTFW21708	F	1/2	12,7	27	18,6	9,5